

# MARINE CATALOGUE



**KAGI**  
TRADE SMARTER



[www.kagi-intl.com](http://www.kagi-intl.com)

# TABLE OF CONTENTS

## Marine Hardware

- Boat Anchors	P02
- Anchor Connectors & Rollers	P06
- Anchor Chains & Chain Stoppers	P07
- Bollards, Fairleads & cleats	P09
- Deck Hinges	P22
- Pipe Rails & Stanchions	P24
- Fixing Hinges	P35
- Pull Rings, Locks & Clamp Latches	P42
- Drain Plugs	P47
- Rod Holders	P48
- Thru-Hull Plugs	P54
- Drain Cockpits	P55
- Deck Fillers	P57
- General Hardware	P61
- Rigging Hardware	P63
- Antena Bases	P74
- Steerign Wheels	P75
- Ladders	P78
- Hatch	P83
- Porthole	P84

## General Marine Equipment

- Safety Equipment	P85
- Kayak Equipment	P87
- Stand-Up Paddle Boards	P89
- Racing Paddle Boards	P90
- Giant Paddle Boatos	P91
- Fishing Paddle Boards	P92
- Window Paddle Boards	P93
- Paddle Equipment	P94





## MARINE HARDWARE: Boat Anchors



### AISI 316 STAINLESS STEEL PLOUGH ANCHOR

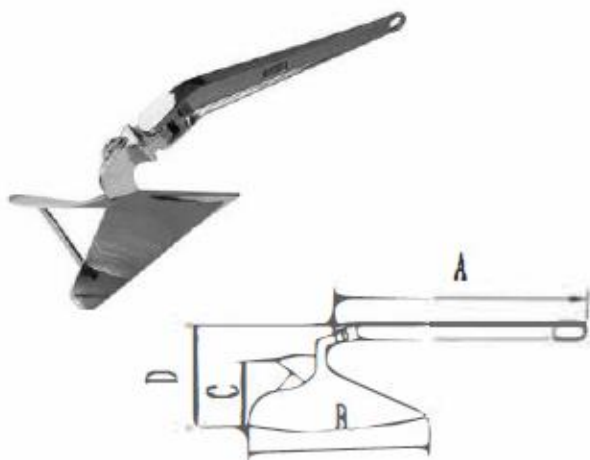

Code	A mm	B mm	C mm	D mm	Weight kg
TR6105	510	340	260	220	5 kg
TR6107	560	380	270	230	7 kg
TR6109	600	375	280	250	9 kg
TR6110	620	400	290	270	10 kg
TR6112	660	430	340	300	12 kg
TR6115	730	490	360	330	15 kg
TR6116	735	490	360	240	16 kg
TR6120	740	550	370	360	20 kg
TR6122	750	550	370	390	22 kg
TR6127	780	600	460	360	27 kg
TR6134	800	630	480	360	34 kg
TR6135	820	640	490	380	35 kg

### AISI 316 STAINLESS STEEL BRUCE ANCHOR

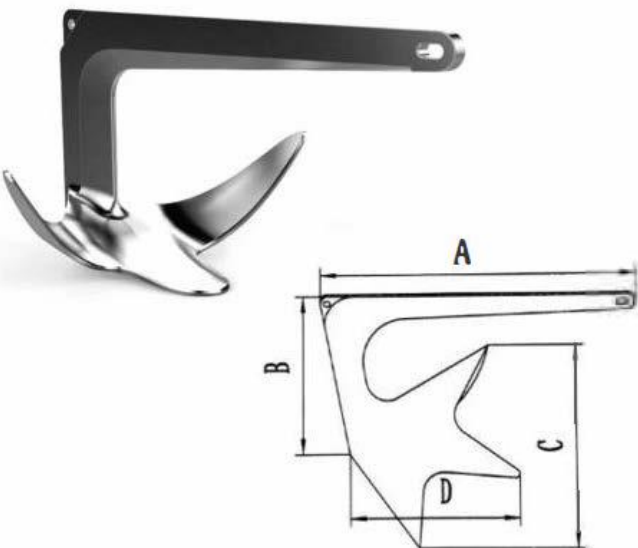

Code	A mm	B mm	C mm	D mm	Weight kg
TR6001	280	102	180	130	1 kg
TR6002	350	127	220	175	2 kg
TR60025	400	150	230	140	2.5KG
TR6003	400	145	250	200	3 kg
TR6005	470	165	310	270	5 kg
TR6075	540	190	350	290	7.5 kg
TR6010	595	210	385	320	10 kg
TR6015	680	255	440	360	15 kg
TR6020	750	300	520	390	20 kg
TR6025	810	310	590	410	25 kg
TR6030	860	320	590	460	30 kg
TR6040	935	370	660	460	40 kg
TR6050	1010	375	700	500	50 kg
TR6080	1050	460	700	547	80 kg

Code	A mm	B mm	C mm	Weight kg
TR6204	550	230	210	4 kg
TR6205	555	250	220	5 kg
TR6275	625	300	270	7.5 kg
TR6208	580	290	270	8 kg
TR6210	665	310	300	10 kg
TR6215	755	350	330	15 kg
TR6020	830	370	390	20 kg
TR6230	970	400	450	30 kg
TR6240	1100	430	490	40 kg
TR6250	1170	450	520	50 kg
TR6263	1270	520	565	63 kg
TR6280	1350	600	605	80 kg
TR62100	1500	750	700	100 kg

### AISI316 STAINLESS STEEL DELTA ANCHOR

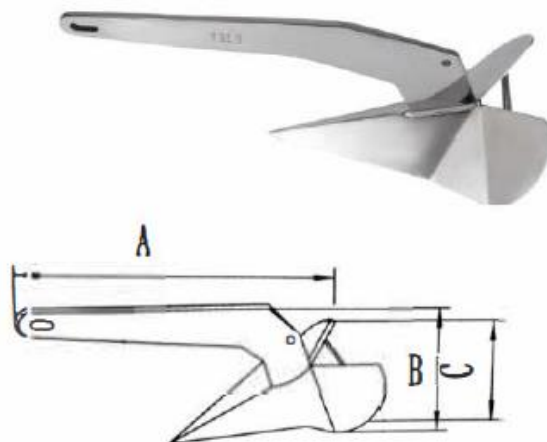

### AISI316 STAINLESS STEEL GRAPNEL ANCHOR

Code	A mm	B mm	C mm	Weight kg
TR63007	510	340	260	0.7 kg
TR63015	560	380	270	1.5 kg
TR63025	600	375	280	2.5 kg
TR63032	620	400	290	3.2 kg
TR6304	660	430	340	4 kg
TR6305	730	490	360	5 kg
TR6306	735	490	360	6 kg
TR6307	740	550	370	7 kg
TR6308	750	550	370	8 kg
TR6310	780	600	460	10 kg
TR6312	800	630	480	12 kg

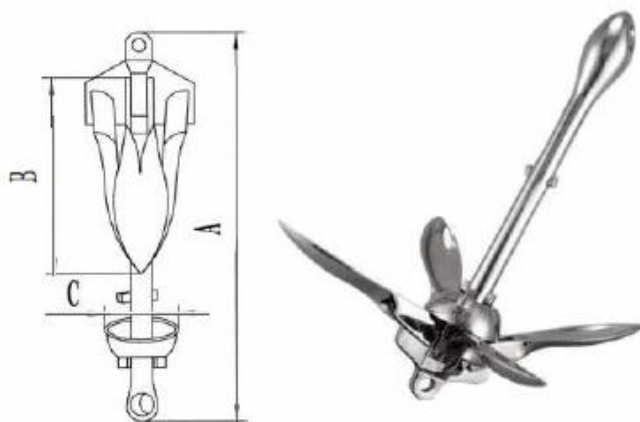

### AISI316 STAINLESS STEEL DANFORTH ANCHOR

Code	A mm	B mm	C mm	Weight kg
TR64005	440	650	155	5 kg
TR64075	550	690	160	7.5 kg
TR64010	600	740	190	10 kg
TR64012	650	765	210	12 kg
TR6415	700	880	215	15 kg
TR6420	740	920	230	20 kg
TR6430	830	1050	270	30 kg
TR6440	890	1100	290	40 kg
TR6450	910	1150	300	50 kg
TR6470	1000	1300	320	70 kg
TR64100	1100	1400	350	100 kg

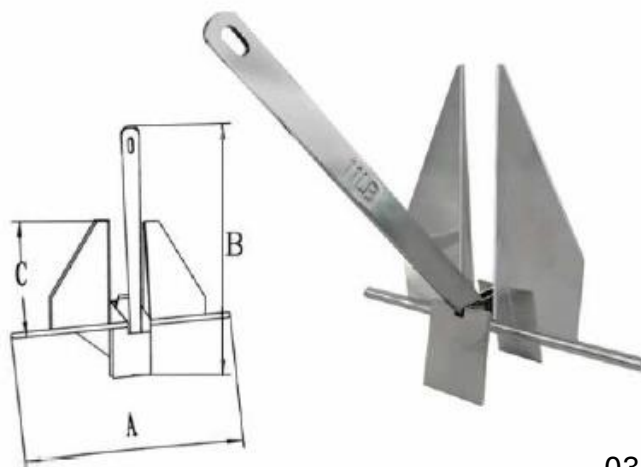



## AISI316 STAINLESS STEEL POOL ANCHOR

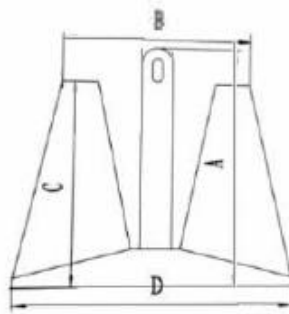

Code	A mm	B mm	C mm	D mm	Weight kg
TR6512	425	315	275	240	12 kg
TR6520	455	385	300	325	20 kg
TR6525	480	410	320	340	25 kg
TR6530	505	430	335	365	30 kg
TR6535	530	460	350	390	35 kg
TR6545	575	490	375	415	45 kg
TR6560	665	555	425	470	60 kg
TR65100	775	655	505	555	100 kg
TR65120	825	700	540	595	120 kg
TR65140	870	735	570	625	140 kg
TR65160	905	765	590	650	160 kg

## HOT DIP GALVANIZED BRUCE ANCHOR



Code	Weight kg	Code	Weight kg
TR7001	1 kg	TR725	25 kg
TR7002	2 kg	TR730	30 kg
TR7003	3 kg	TR735	35 kg
TR7035	3.5 kg	TR740	40 kg
TR7005	5 kg	TR745	45 kg
TR7075	7.5 kg	TR750	50 kg
TR710	10 kg	TR755	55 kg
TR715	15 kg	TR760	60 kg
TR720	20 kg	TR780	80 kg

## HOT DIP GALVANIZED PLOUGH ANCHOR



Code	Weight kg	Code	Weight kg
TR7105	5 kg	TR7120	20 kg
TR7107	7 kg	TR7122	22 kg
TR7109	9 kg	TR7124	24 kg
TR7112	12 kg	TR7127	27 kg
TR7115	15 kg	TR7135	35 kg
TR7116	16 kg	TR7140	40 kg

## HOT DIP GALVANIZED DELTA ANCHOR



Code	Weight kg	Code	Weight kg
TR7204	4 kg	TR7220	20 kg
TR7205	5 kg	TR7225	25 kg
TR7275	7.5 kg	TR7230	30 kg
TR7208	8 kg	TR7232	32 kg
TR7210	10 kg	TR7240	40 kg
TR7216	16 kg	TR7250	50 kg

## HOT DIP GALVANIZED DANFORTH ANCHOR

Code	Weight kg	Code	Weight kg
TR7302	2 kg	TR7315	15 kg
TR73025	2.5 kg	TR7320	20 kg
TR7303	3 kg	TR7325	25 kg
TR7304	4 kg	TR7330	30 kg
TR7305	5 kg	TR7340	40 kg
TR7306	6 kg	TR7350	50 kg
TR7308	8 kg	TR7370	70 kg
TR7310	10 kg	TR7380	80 kg
TR7312	12 kg	TR73100	100 kg



## HOT DIP GALVANIZED GRAPNEL ANCHOR

Code	Weight kg	Code	Weight kg
TR74015	1.5 kg	TR7410	10 kg
TR74025	2.5 kg	TR7412	12 kg
TR74032	3.2 kg	TR7415	15 kg
TR7404	4 kg	TR7420	20 kg
TR7406	6 kg	TR7425	25 kg
TR7408	8 kg	TR7430	30 kg



## BLACK PAINTED HALL ANCHOR

Code	A (mm)	L (mm)	L1 (mm)	R1 (mm)	B (mm)	B1 (mm)	NOMINAL WEIGHT(kg)
TR75300	1190	844	595	130	328	388	300 kg
TR75350	1250	890	625	137	344	408	350 kg
TR75400	1310	930	650	143	360	428	400 kg
TR75450	1360	970	675	149	376	444	450 kg
TR75500	1410	1000	700	154	390	460	500 kg
TR75600	1500	1060	745	164	414	490	600 kg
TR75700	1580	1120	785	172	436	516	700 kg
TR75800	1650	1170	820	180	456	540	800 kg
TR75900	1720	1220	855	188	474	560	900 kg
TR751000	1780	1260	885	194	490	580	1000 kg
TR751250	1910	1360	955	109	526	624	1250 kg
TR751500	2030	1450	1015	222	560	664	1500 kg
TR752250	2330	1650	1160	254	642	760	2250 kg
TR752500	2410	1710	1200	263	666	788	2500 kg
TR753000	2560	1820	1275	280	708	836	3000 kg
TR753500	2700	1920	1345	294	746	880	3500 kg
TR754000	2820	2000	1400	308	780	920	4000 kg
TR754500	2940	2080	1455	320	808	956	4500 kg
TR755000	3050	2150	1510	332	836	992	5000 kg

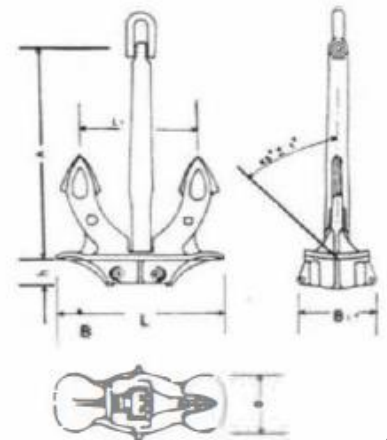





## MARINE HARDWARE: Anchor Connectors & Anchor Rollers



### AISI316 STAINLESS STEEL ANCHOR CONNECTOR

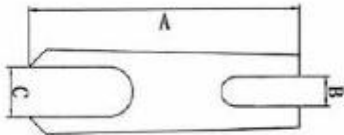

Code	A mm	B mm	C mm	Chain Size
TR801A-0608	91	10.5	15.5	6-8
TR801B-1012	117	13	19	10-12

### AISI316 STAINLESS STEEL ANCHOR DOUBLE CONNECTOR

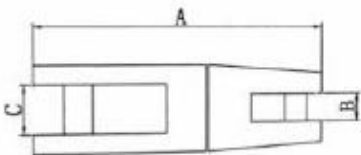

Code	A mm	B mm	C mm	Chain Size
TR802A-0608	90	10.5	15.5	6-8
TR802B-1012	118	13	18	10-12
TR802C-1416	141	18	31	14-16

### AISI316 STAINLESS STEEL HEAVY ANCHOR DOUBLE CONNECTOR

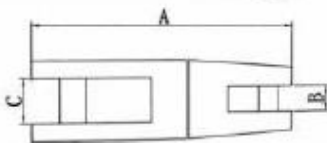

Code	A mm	B mm	C mm	Chain Size
TR803A-0608	90	10.5	15.5	6-8
TR803B-1012	141	18	31	10-12

## AISI316 STAINLESS STEEL ANCHOR DOUBLE CONNECTOR

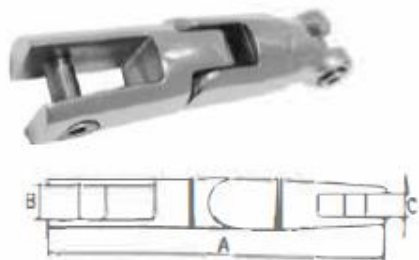

Code	A mm	B mm	C mm	Chain Size
TR804A-0608	120	15	10.5	6-8
TR804B-1012	151	18	13	10-12

## AISI316 STAINLESS STEEL ANCHOR CONNECTOR

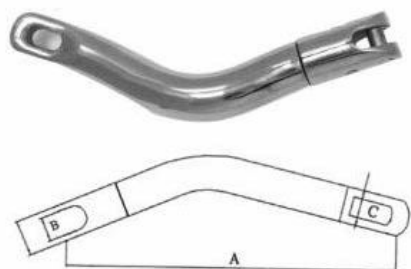

Code	A mm	B mm	C mm	Chain Size
TR805A-0608	230	10	11	6-8
TR805B-1012	305	14	15	10-12

## AISI316 STAINLESS STEEL BOW ROLLER

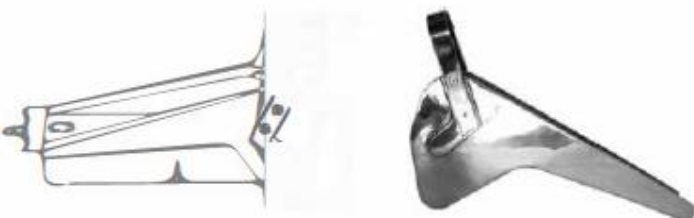

Code	A mm	B mm	C mm	Chain mm
TR901A	350	65	280	6/8
TR901B	490	70	340	8/10
TR901C	490	80	300	10/12

## AISI316 STAINLESS STEEL BOW ROLLER

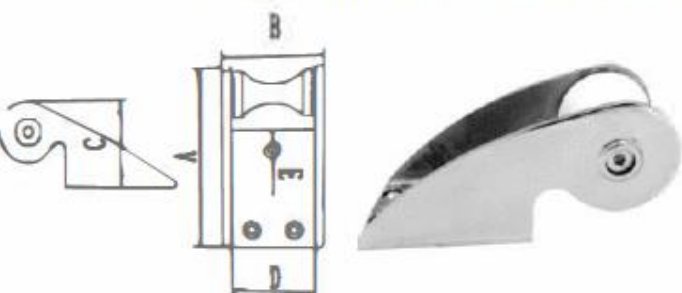

Code	A mm	B mm	C mm	D mm	E mm
TR902A	165	64	73	54	8



**AISI316 STAINLESS STEEL BOW ROLLER**



Code	Length mm	Width mm	Height mm
TR904A	197	62	70

**AISI316 STAINLESS STEEL BOW ROLLER**



Code	Length mm	Width mm
TR905A	390	46
TR906B	455	87

**AISI316 STAINLESS STEEL BOW ROLLER**



Code	Length mm	Width mm
TR907A	495	67

**AISI316 STAINLESS STEEL BOW ROLLER**



Code	Length mm	Width mm	Height mm
TR903A	155	51	70



# KAGI

TRADE SMARTER



## MARINE HARDWARE: Anchor Chains & Chain Stoppers



### DIN766 LINK CHAINS



Code	Dia mm	L.W.	O.W.	Breaking load kn.
TR9103	3	16	11	4.1
TR9104	4	16	13.7	8
TR9105	5	18.5	17	12.5
TR9106	6	18.5	20.2	16
TR9107	7	22	23.8	25
TR9108	8	24	27.2	32
TR9109	9	27	30.6	40
TR91010	10	30	34	50
TR91011	11	31	37.4	63
TR91012	12	34	40.8	66
TR91013	13	36	44.2	80
TR91014	14	41	47.5	100
TR91016	16	45	54.4	125

### DIN763 LINK CHAIN



Code	Dia mm	I.L.	O.W.	Breaking load kn.
TR9204	4	32	16	6
TR9205	5	35	20	10
TR9206	6	42	24	14
TR9207	7	49	24	18
TR9208	8	52	32	25
TR9209	9	59	36	32
TR9210	10	65	40	40
TR9211	11	72	44	47.5
TR9212	12	78	48	56.5
TR9213	13	82	52	63



**DIN5685 SHORT LINK CHAIN**



Code	Dia mm	I.L.	O.W.	Breaking load kn.
TR9304	4	19	16	5
TR9305	5	21	20	7.75
TR9306	6	24	24	11.5
TR9307	7	28	28	15
TR9308	8	32	32	20
TR9309	9	36	36	25
TR9310	10	40	40	31
TR9311	11	44	44	38
TR9312	12	48	48	45

**DIN5685 LONG LINK CHAIN**



Code	Dia mm	I.L.	O.W.	Breaking load kn.
TR9404	4	32	16	5.5
TR9405	5	35	20	8.5
TR9406	6	42	24	13.5
TR9407	7	49	28	17
TR9408	8	52	32	23
TR9409	9	59	36	28.5
TR9410	10	65	40	34.5
TR9411	11	72	44	41
TR9412	12	78	48	49
TR9413	13	82	52	53

**AISI316 STAINLESS STEEL CHAIN STOPPER**



Code	L mm	W mm
ALS3013	125	84

**AISI316 STAINLESS STEEL CAM CLEAT**



Code	L mm	W mm
ALS3015	69	17
ALS3016	81	18

**AISI316 STAINLESS STEEL CHAIN LOCK STOPPER**



Code	L mm	W mm
ALS3017	121	66

**AISI316 STAINLESS STEEL ROPE CLAMP CAM CLEAT**

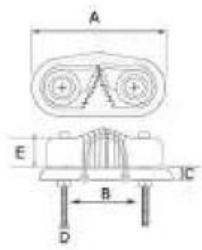

Code	Amm	Bmm	Cmm	Dmm	Emm
ALSH004	68	18.5	7	M5	15.5

**AISI316 STAINLESS STEEL ANCHOR CHAIN STOPPER**



Code	Amm	Bmm	Cmm	Size
ALS0680A	59.5	53.5	48	6-8
ALS0680B	80.2	70	62	10-12





# KAGI

TRADE SMARTER



## MARINE HARDWARE: Boat Bollards, Fairleads & Cleats

### AISI316 STAINLESS STEEL SINGLE BOLLARD

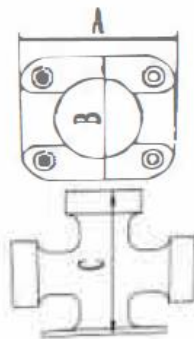

Code	A mm	B mm	C mm
TR9401	62	62	81

### AISI316 STAINLESS STEEL DOUBLE CROSS BOLLARD

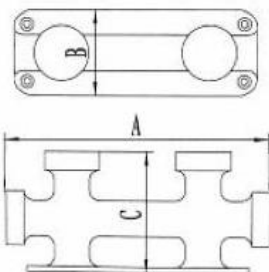

Code	A mm	B mm	C mm
TR9402	166	63	88

### AISI316 STAINLESS STEEL SINGLE BOLLARD



Code	L mm	W mm	H mm
TR9403	85.6	61.8	98

### AISI316 STAINLESS STEEL SINGLE BOLLARD

Code	Size	A	B	C	D
TR950A	6"	100	100	42	152
TR950B	8"	135	135	50	190
TR950C	10"	190	150	80	190
TR950D	12"	260	260	80	381

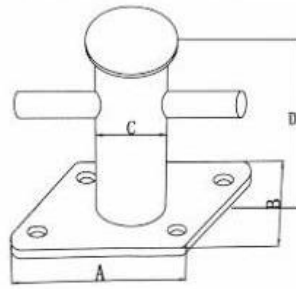

### AISI316 STAINLESS STEEL DOUBLE CROSS BOLLARD

Code	Size	A	B	C
TR951A	6"	190	310	130
TR951B	8"	190	370	150
TR951C	10"	260	500	180

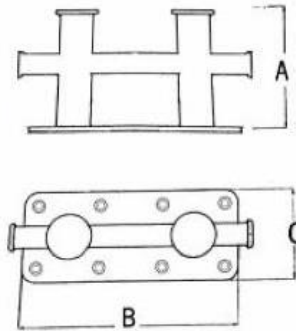

### AISI316 STAINLESS STEEL BOLLARD

Code	A mm	B mm	C mm	D mm
TR952A	120	95	120	62
TR652B	150	120	150	76

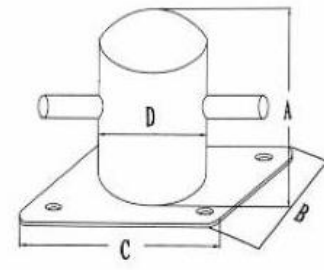

### AISI316 STAINLESS STEEL BOLLARD

Code	Size	A mm	B mm	C mm
TR953A	6"	152	60	62
TR953B	8"	203	70	77
TR953C	10"	255	80	91
TR953D	12"	310	90	109

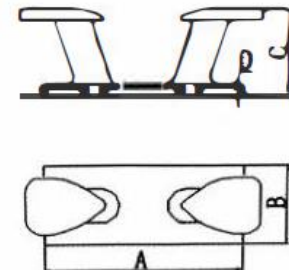



**AISI316 STAINLESS STEEL BOLLARD**



Code	A mm
TR954A	295

**AISI316 STAINLESS STEEL DOCK BOLLARD**

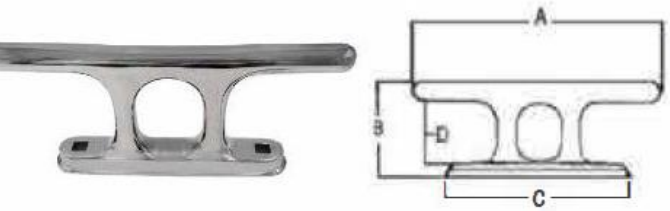

Code	Size	A	B	C	D
TR955A	10"	265	100	200	65
TR955B	12"	305	120	225	81

**AISI316 STAINLESS STEEL DOCK BOLLARD**

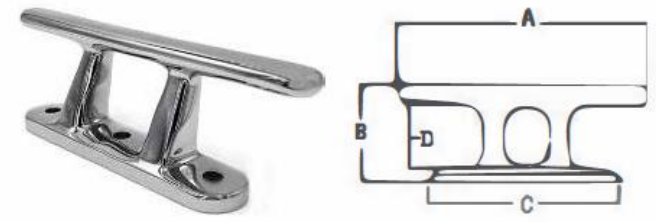

Code	A mm	B mm	C mm	D mm
TR956A	302	102	229	70

**AISI316 STAINLESS STEEL FAIRLEAD ROLLER**

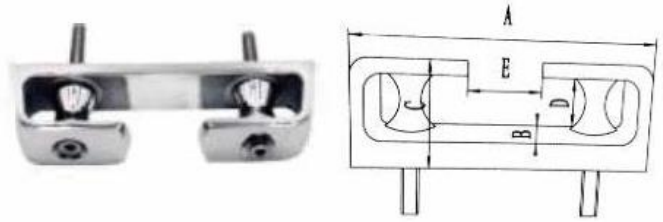

Code	A mm	B mm	C mm	D mm	E mm
TR960A	200	41	57	35	43
TR960B	250	45	80	49	44

### AISI316 STAINLESS STEEL FAIRLEAD ROLLER

Code	L mm	W mm
TR961	340	160

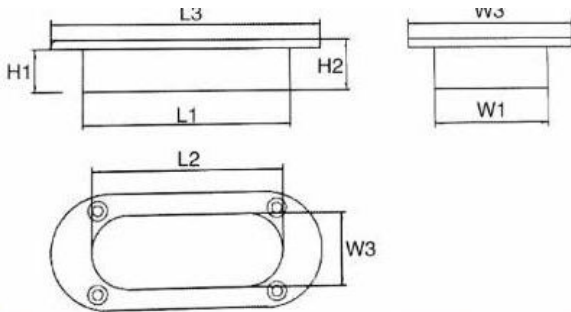
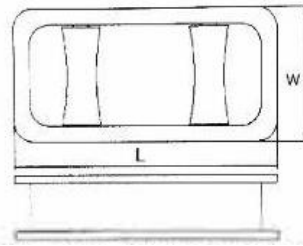

### AISI316 STAINLESS STEEL HAWSE PIPE



Code	L1 mm	L2 mm	L3 mm	W1 mm	W2 mm	W3 mm	H1 mm	H2 mm
TR962A	103	95	138	47	38	61	23	28
TR962B	188	175	237	88	75	136	24.6	30.6

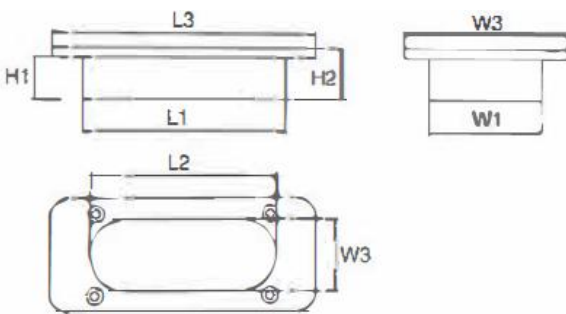

### AISI316 STAINLESS STEEL HAWSE PIPE



Code	L1 mm	L2 mm	L3 mm	W1 mm	W2 mm	W3 mm	H1 mm	H2 mm
TR963A	128	120	151	58	50	81	30.7	37.2

### AISI316 STAINLESS STEEL BOW CHOCK HEAVY

Code	Pair	A mm	B mm	C mm	D mm
TR964A	Left	280	80	85	100
	Right	280	80	85	100

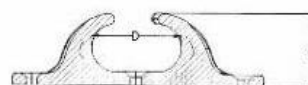
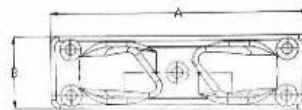



### AISI316 STAINLESS STEEL BOW CHOCK

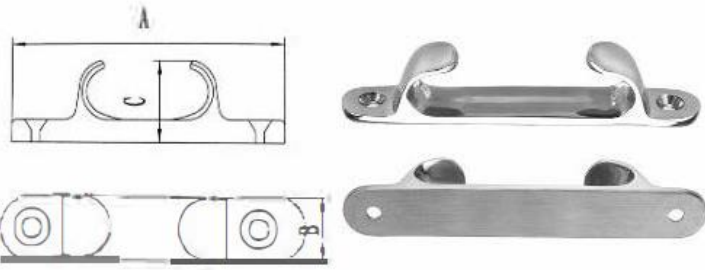

Code	Size	A mm	B mm	C mm
TR965A	4inch	100	19	27
TR965B	5 inch	125	21	32
TR965C	6 inch	152	22	32
TR965D	8 inch	203	36	38
TR965E	10inch	254	45	40

### AISI316 STAINLESS STEEL BOW CHOCK



Code	Size	A mm	B mm	C mm
TR966A	5inch	125	19	23.5
TR966B	6inch	152	24	26.3

A pair, Left & Right

### AISI316 STAINLESS STEEL BOW CHOCK

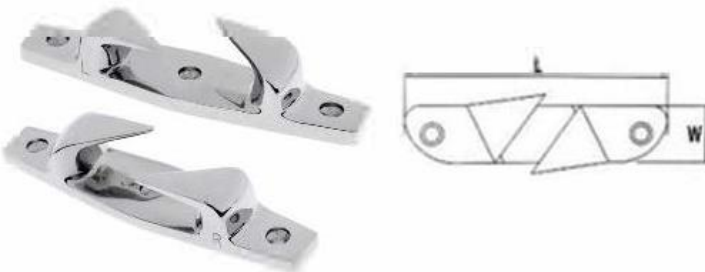

Code	Size	L mm	W mm	Screw
TR968A	4-1/2inch	118	22	8
TR968B	6inch	152	35	8

A pair, Left & Right

### AISI316 STAINLESS STEEL TRIANGLE BOW CHOCK

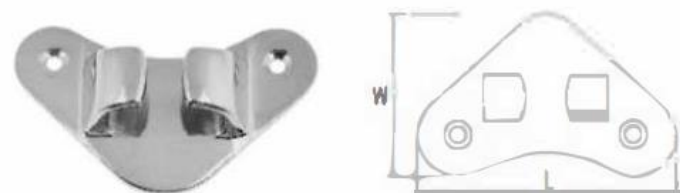

Code	L mm	W mm
TR969A	107	65

## AISI316 STAINLESS STEEL TRIANGLE BOW CHOCK

Code	SIZE
TR970A	63mm*25mm



## AISI316 STAINLESS STEEL HOLLOW BASE CLEAT

Code	Size	A mm	B mm	C mm
TR1004	4inch	101	36	25
TR1005	5 inch	127	39	30
TR1006	6 inch	150	46	30
TR1008	8 inch	203	53	40
TR1010	10 inch	255	64	45
TR1012	12 inch	305	70	53
TR1015	15 inch	378	78	64

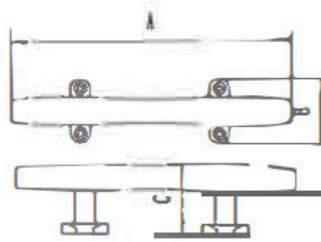

## AISI316 STAINLESS STEEL HEAVY DUTY CLEAT

Code	Size	A mm	B mm	C mm
TR1104	4inch	100	36	27
TR1105	5inch	126	38	29
TR1106	6 inch	152	44	30
TR1108	8 inch	203	54	38
TR1110	10 inch	252	65	44
TR1112	12inch	304	70	53

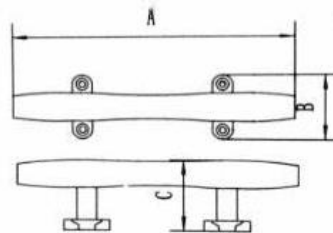

## AISI316 STAINLESS STEEL SILHOUETTE CLEAT

Code	Size	A mm	B mm	Cmm
TR1204	4inch	100	36	25
TR1205	5inch	125	46	25
TR1206	6inch	152	56	28
TR1208	8inch	201	62	31
TR1210	10inch	252	64	40
TR1212	12inch	302	75	50

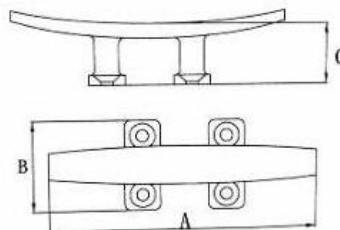



### AISI316 STAINLESS STEEL MAST CLEAT

Code	Size	A mm	B mm	C mm
TR1304	4inch	100	13	30.2
TR1305	5inch	125	17	35.5
TR1306	6inch	152	19	39.5
TR1308	8inch	203	23	45.2
TR1310	10inch	252	24	47.6

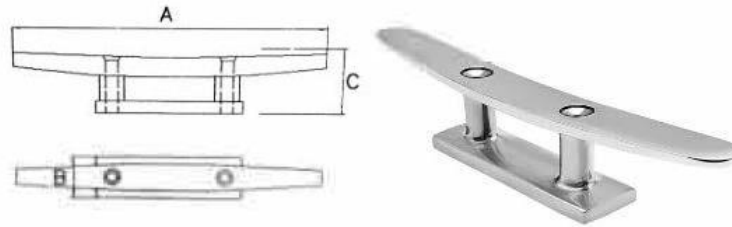

### AISI316 STAINLESS STEEL CLEAT

Code	L mm	H mm
TR2301A	153	46



### AISI316 STAINLESS STEEL HANDRAIL CLEAT

Code	L mm	H mm
TR2401A	143	43



### AISI316 STAINLESS STEEL FOLDING CLEAT

Code	Size	A mm	B mm
TR2505	5 inch	127	43
TR2506	6 inch	155	52
TR2508	8 inch	203	73



### AISI316 STAINLESS STEEL FOLDING CLEAT WITH THREAD

Code	L mm	B mm	H mm
TR2605	126	44	110
TR2606	155	54	135
TR2608	210	73	150

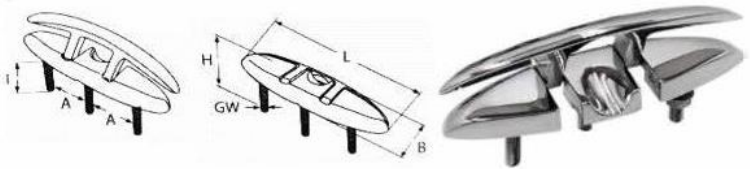

### AISI316 STAINLESS STEEL FIUSH POP UP CLEAT

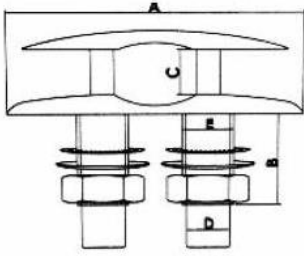

Code	A mm	B mm	C mm	E mm
TR2705	125	45	23	22
TR2706	160	45	20.5	22

### AISI316 STAINLESS STEEL HEAVY POP UP CLEAT

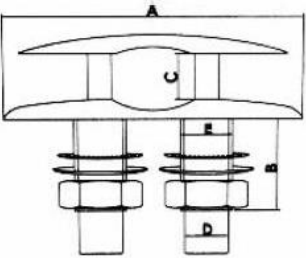

Code	A mm	B mm	C mm	E mm
TR2715B	125	42	20	22
TR2716B	152	43	20.5	22

### AISI316 STAINLESS STEEL HUMPBACKED CLEAT

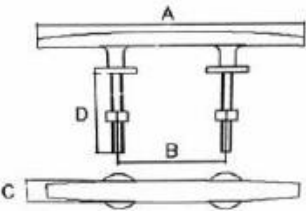

Code	Size	A mm	B mm	C mm	D mm
TR1406	6inch	150	63	18	45
TR1408	8inch	200	84	22.5	45
TR1410	10inch	250	106	28.3	45

### AISI316 STAINLESS STEEL HUMPBACKED CLEAT

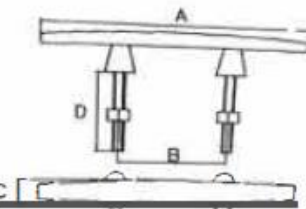

Code	Size	A mm	B mm	C mm	D mm
TR1506	6inch	150	46.2	15.6	47.3
TR1508	8inch	200	58.2	20	47.3
TR1510	10inch	250	74.6	24.5	47.3

### AISI316 STAINLESS STEEL CLEAT



Code	L mm	W mm	H1 mm	H2 mm
TR1705	125	26	44	45
TR1706	150	45	56	45

### AISI316 STAINLESS STEEL CLEAT

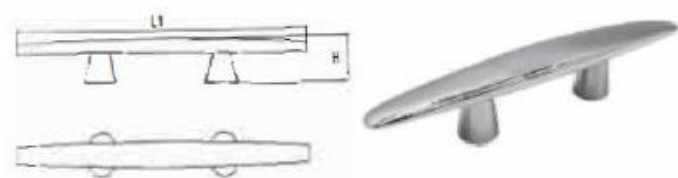

Code	Size	L1 mm	H mm
TR1908	8inch	205	35
TR1910	10inch	250	45
TR1912	12inch	304	47
TR1915	15inch	385	55

### AISI316 STAINLESS STEEL CLEAT "K"



Code	L mm	H mm
TR2108A	215	43

### AISI316 STAINLESS STEEL RING CLEAT COMBI

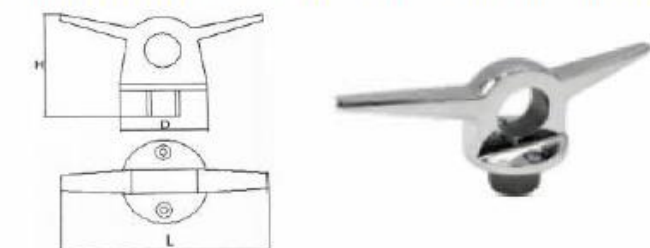

Code	L mm	D mm	H mm
TR2201A	175	62	68



### AISI316 STAINLESS STEEL FLUSH CLEAT



Code	Size	A mm	B mm	C mm
TR2805	5 inch	130	32	65
TR2806	6 inch	160	35	70
TR2808	8 inch	210	45	96
TR2810	10 inch	260	57	121
TR2812	12 inch	310	69	125

### AISI316 STAINLESS STEEL CLEAT With screw rod



Code	A mm	B mm
TR2910	260	58
TR2912	300	65

### AISI316 STAINLESS STEEL BOLLARD CLEAT

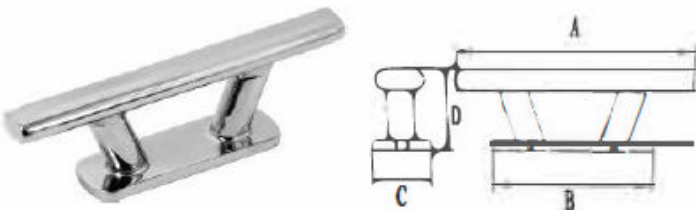

Code	Size	A	B	C	D
TR3006	6"	150	118	19	53
TR3008	8"	215	137	34	56
TR3010	10"	265	150	40	68
TR3012	12"	310	175	50	78

### AISI316 STAINLESS STEEL ANCHOR CHAIN&STOPPER



Code	L mm	W mm
TR3013	125	84



## MARINE HARDWARE: Deck hinges



### 316 STAINLESS STEEL DECK HINGE 90°

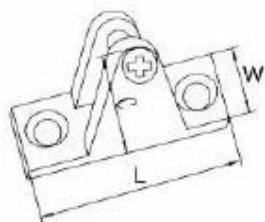

Code	L mm	W mm
TR5401	61	18.7

### 316 STAINLESS STEEL DECK HINGE 90°-REMOVABLE

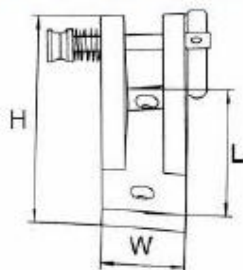

Code	L mm	W mm
TR5402	61	18.7

### 316 STAINLESS STEEL CONCAVE BASE DECK HINGE

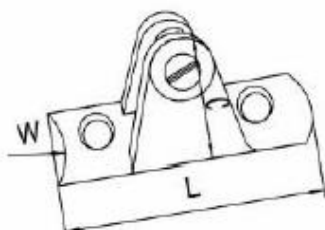

Code	L mm	Wmm	For pipe mm
TR5404A	61	18.5	22.5
TR5404B	61	18.5	25.5

**316 STAINLESS STEEL CONCAVE BASE DECK HINGE - REMOVABLE PIN**

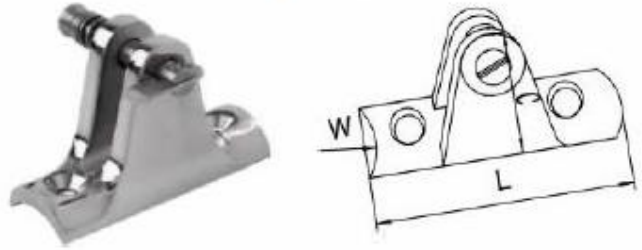

Code	L mm	Wmm	For pipe mm
TR5410A	61	18.5	22.5
TR5410B	61	18.5	25.5

**316 STAINLESS STEEL DECK HINGE 60°**

Code	L mm	W mm
TR5411	56	18.5

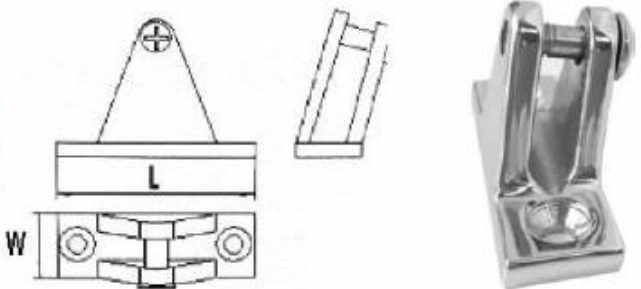

**316 STAINLESS STEEL DECK HINGE 60°-REMOVABLE PIN**

Code	L mm	W mm
TR5412	61	18.5

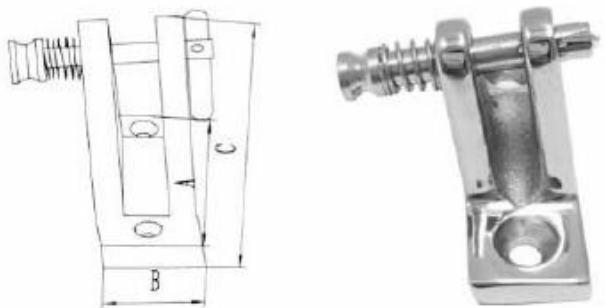

**AISI316 STAINLESS STEEL DECK HINGE 90°**

Code	A mm	B mm	C mm
TR5413A	50.8	22.3	25
TR5413B	50.8	32.5	28

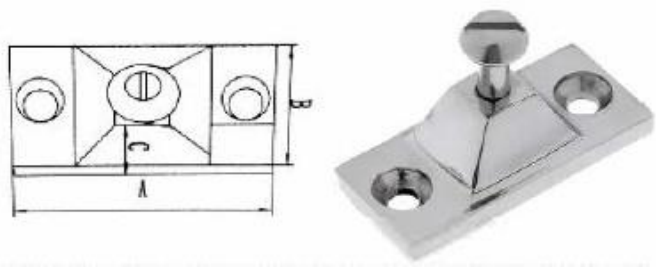





## MARINE HARDWARE: Pipes & Rails Stanchions



**AISI316 STAINLESS STEEL HANDRAIL 30° ROUND BASE**

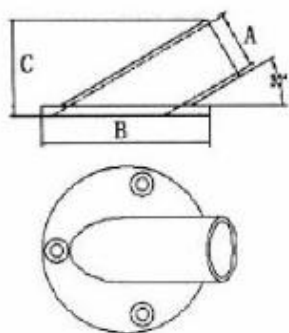

Code	Size	A mm	B mm	C mm
TR5413-3022	7/8"	22.5	66.3	37.8
TR5413-3025	1"	25.6	72.2	36.7

**AISI316 STAINLESS STEEL HANDRAIL 45° ROUND BASE**

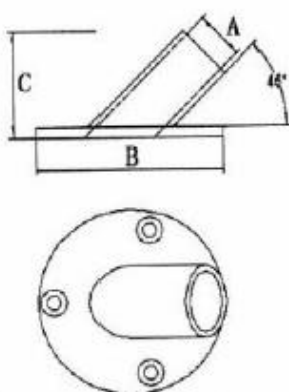

Code	Size	A mm	B mm	C mm
TR5414-4522	7/8"	22.5	66.3	38.1
TR5414-4525	1"	25.5	72.2	37.9

**AISI316 STAINLESS STEEL HANDRAIL 60° ROUND BASE**

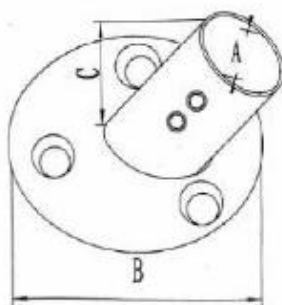

Code	Size	A mm	B mm	C mm
TR5415-6022	7/8"	22.5	66.3	41.1
TR5415-6025	1"	25.5	72.2	40
TR5415-6030	1-1/5"	30.5	71.5	46
TR5415-6032	1-1/4"	32.5	71.5	46

### AISI316 STAINLESS STEEL HANDRAIL 90° ROUND BASE

Code	Size	A mm	B mm	C mm
TR5416-9022	7/8"	22.5	66	44.7
TR5416-9025	1"	25.5	69	44.7
TR5416-9030	1-1/5"	30.5	72	43.2
TR5416-9032	1-1/4"	32.5	75	43.2

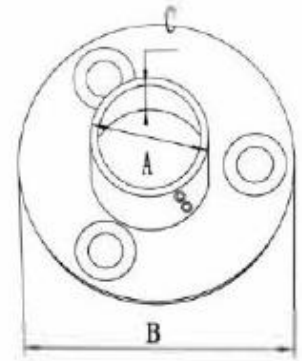

### AISI316 STAINLESS STEEL HANDRAIL 30° RECTANGULAR BASE

Code	Size	A	B	C	D
TR5417-3022	7/8"	78.7	44	35.6	22.5
TR5417-3025	1"	82	47.3	38	25.5

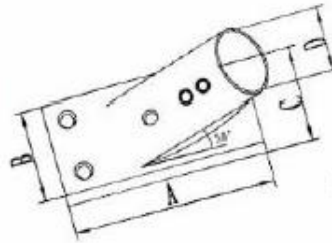

### AISI316 STAINLESS STEEL HANDRAIL 45° RECTANGULAR BASE

Code	Size	A	B	C	D
TR5418-4522	7/8"	78.7	44	39	22.5
TR5418-4525	1"	82	47.3	43.6	25.5

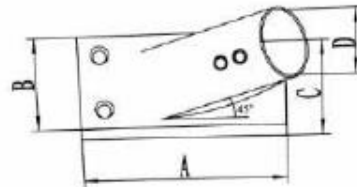

### AISI316 STAINLESS STEEL HANDRAIL 60° RECTANGULAR BASE

Code	Size	A	B	C	D
TR5419-6022	7/8"	79	44	39	22.5
TR5419-6025	1"	82	47.3	44	25.5
TR5419-6030	1-1/5"	86	52	51.6	30.5
TR5419-6032	1-1/4"	86	52	51	32.5

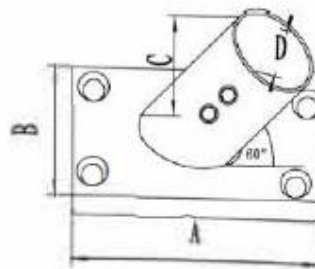



**AISI316 STAINLESS STEEL HANDRAIL 90° RECTANGULAR BASE**

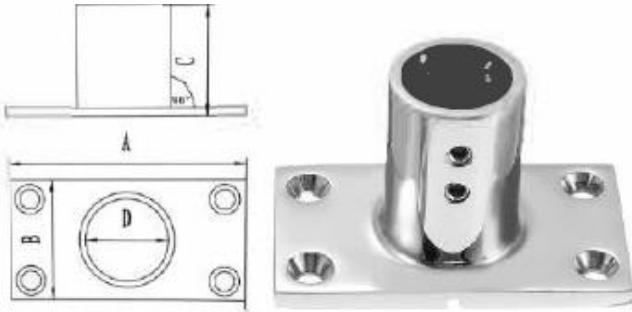

Code	Size	A	B	C	D
TR5420-9022	7/8"	79	44	44	22.5
TR5420-9025	1"	82	47	47	25.5
TR5420-9030	1-1/5"	86	52	51	30.5
TR5420-9032	1-1/4"	87	52	53	32.5

**AISI316 STAINLESS STEEL HANDRAIL 45° WELDABLE ROUND BASE**

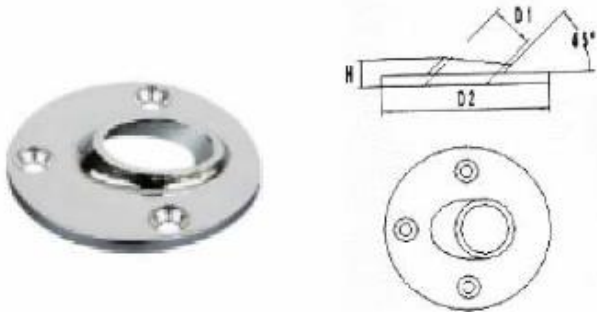

Code	Size	D1 mm	D2mm	H mm
TR5430-22	7/8"	22.5	66	13
TR5430-25	1"	25.5	80	10

**AISI316 STAINLESS STEEL HANDRAIL 60° WELDABLE ROUND BASE**



Code	Size	D1mm	D2mm	H mm
TR5431-22	7/8"	22.5	66	13
TR5431-25	1"	25.5	80	16

**AISI316 STAINLESS STEEL HANDRAIL 90° WELDABLE ROUND BASE**



Code	Size	D1mm	D2mm	H mm
TR5432-22	7/8"	22.5	66	16
TR5432-25	1"	25.5	75	16



**AISI316 STAINLESS STEEL HANDRAIL 45° WELDABLE RECTANGULAR BASE**

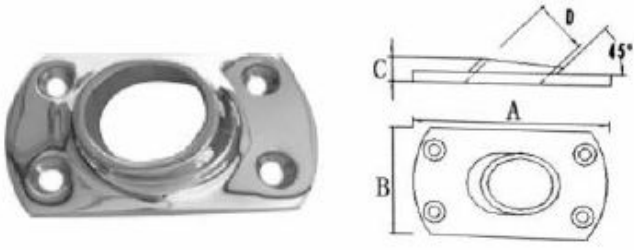

Code	Size	D	L	W	H
TR5435-22	7/8"	22	78	44	12.5
TR5435-25	1"	25	78	44	15

**AISI316 STAINLESS STEEL HANDRAIL 60° WELDABLE RECTANGULAR BASE**

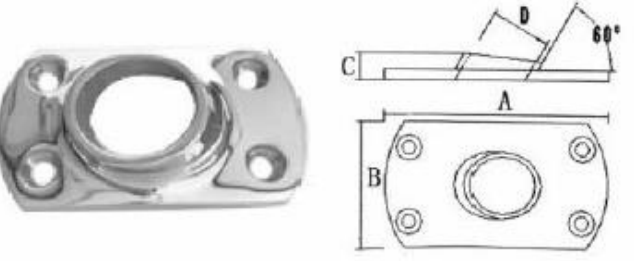

Code	Size	D	L	W	H
TR5436-22	7/8"	22	78	44	13
TR5436-25	1"	25	78	44	14

**AISI316 STAINLESS STEEL HANDRAIL 90° WELDABLE RECTANGULAR BASE**

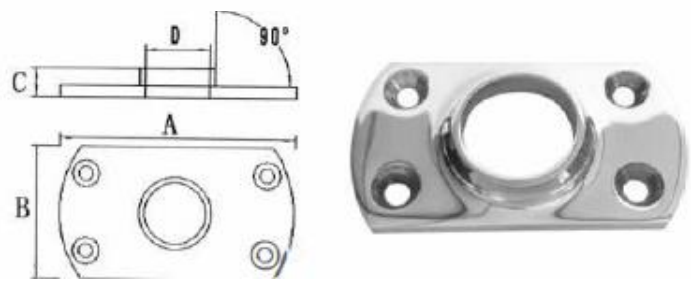

Code	Size	D	L	W	H
TR5437-22	7/8"	22	78	44	16
TR5437-25	1"	25	78	44	16

**AISI316 STAINLESS STEEL 60° STANCHION BASE**

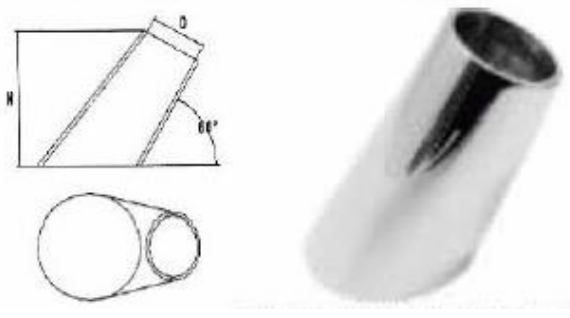

Code	Size	D mm	H mm
TR5438-25	1"	25	69
TR5438-30	1-1/5"	30	80

### AISI316 STAINLESS STEEL 90° STANCHION BASE

Code	Size	A mm	B mm
TR5439-25	1"	25	69
TR5439-30	1-1/5"	30	80

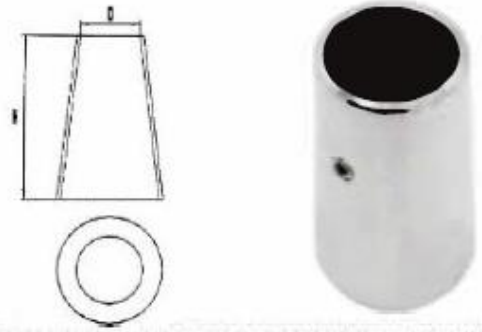

### AISI316 STAINLESS STEEL 60° STANCHION BASE

Code	Size	A mm	B mm
TR5440-25	1"	25	66.5
TR5440-30	1-1/5"	30	61
TR5440-32	1-1/4"	32	61

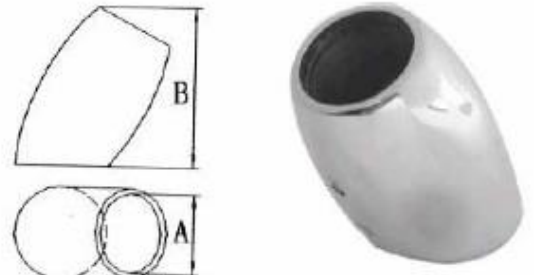

### AISI316 STAINLESS STEEL 90° STANCHION BASE

Code	Size	A mm	B mm
TR5441-25	1"	25	56
TR5441-30	1-1/5"	30	61
TR5441-32	1-1/4"	32	61

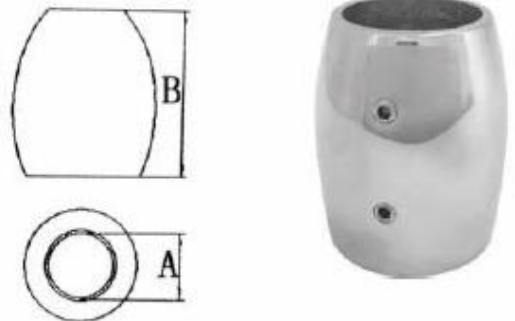

### AISI316 STAINLESS STEEL HANDRAIL FITTING CENTER STANCHION

Code	D mm	H mm
TR5442A-22	22.5	59
TR5442B-25	25.6	64

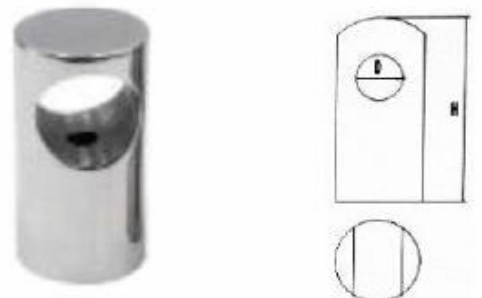

## AISI316 STAINLESS STEEL HANDRAIL FITTING END STANCHION

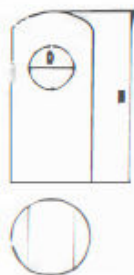

Code	D mm	H mm
TR5443A-22	22.6	59
TR5443B-25	25.7	64

## AISI316 STAINLESS STEEL 90° ELBOW

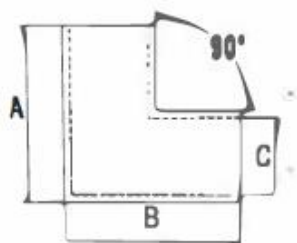

Code	Size	A mm	B mm	C mm
TR5445-22	7/8"	50	50	22.6
TR5445-25	1"	51	51	25.7
TR5445-30	1-1/5"	54	54	30.5
TR5445-32	1-1/4"	55	55	32.6

## AISI316 STAINLESS STEEL 60° HANDRAIL TEE

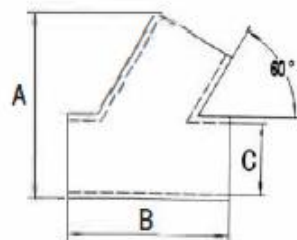

Code	Size	A mm	B mm	C mm
TR5446-22	7/8"	57	48	22.5
TR5446-25	1"	60	52	25.5
TR5446-30	1-1/5"	76	76	30.5
TR5446-32	1-1/4"	76	77	32.6

## AISI316 STAINLESS STEEL 60° LEFT HAND HANDRAIL TEE

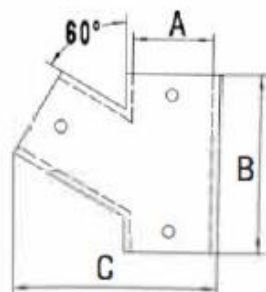

Code	Size	A mm	B mm	C mm
TR5447-22	7/8"	22.6	48	57
TR5447-14	1"	25.5	52	60



### AISI316 STAINLESS STEEL 60° RIGHT HAND HANDRAIL TEE

Code	Size	A mm	B mm	C mm
TR5448-22	7/8"	22.6	48	57
TR5448-25	1"	25.5	52	60

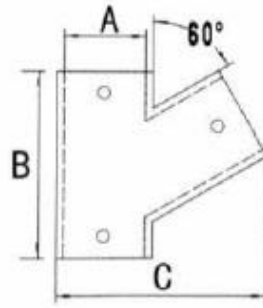

### AISI316 STAINLESS STEEL 90° HANDRAIL TEE

Code	Size	A mm	B mm	C mm
TR5449-22	7/8"	22.5	52	51
TR5449-25	1"	25.5	53	51
TR5449-30	1-1/5"	30.6	76	83
TR5449-32	1-1/4"	32.5	76	88

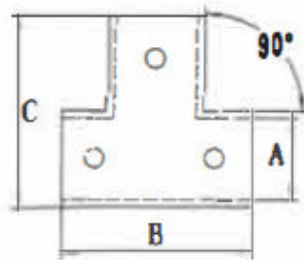

### AISI316 STAINLESS STEEL 90° HANDRAIL TEE

Code	Size	D mm	L mm	W mm
TR5450-22	7/8"	22.5	52	52
TR5450-25	1"	25.5	55	55



### AISI316 STAINLESS STEEL 60° HANDRAIL BASE

Code	Size	D mm	L mm	W mm
TR5451-22	7/8"	22.5	48	57
TR5451-25	1"	25.6	52	60

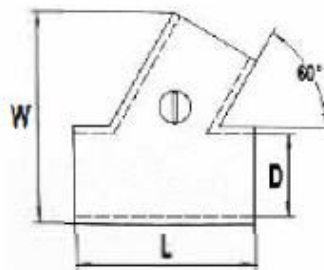

### AISI316 STAINLESS STEEL 60° TEE CONNECTOR

Code	Size	D mm	L mm	W mm
TR5452-22	7/8"	22.5	48	57

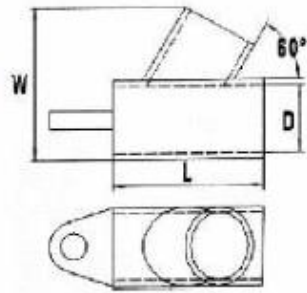

### AISI316 STAINLESS STEEL 90° 2-WAY TEE CONNECTOR

Code	Size	D mm	Degree
TR5456-22	7/8"	22.5	90°

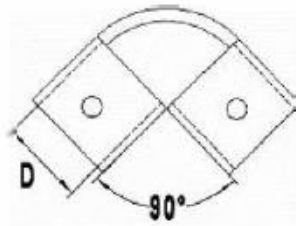

### AISI316 STAINLESS STEEL BLIND BASE

Code	Size	D mm	L mm	H mm
TR5457-25	1"	25.5	87	34.2

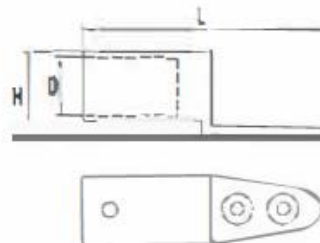

### AISI316 STAINLESS STEEL SWIVEL JOINT FOR BIMINI PIPES

Code	Size	D mm	L mm
TR5458-22	7/8"	22.5	37.4
TR5458-25	1"	25.6	37.7

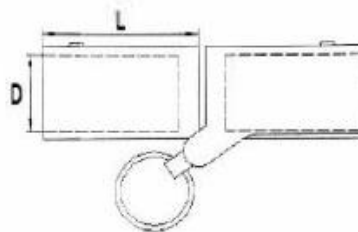

### AISI316 STAINLESS STEEL SWIVEL JOINT FOR BIMINI PIPES

Code	Size	D mm	L mm
TR5459-22	7/8"	22.5	38.2
TR5459-25	1"	25.5	39.2

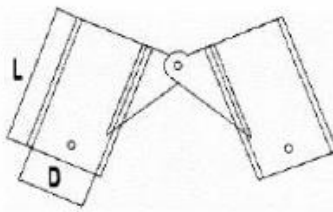

### AISI316 STAINLESS STEEL SWIVEL JOINT FOR BIMINI PIPES

Code	D1 mm	D2 mm
TR5461A-20	17.5	20.2
TR5461B-20	17	20
TR5461C-22	19.4	22
TR5461D-22	18.8	22

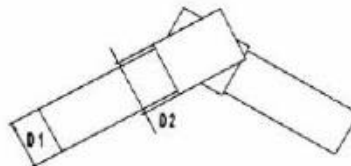

### AISI316 STAINLESS STEEL 90° TEE CONNECTOR

Code	Size	D mm	L mm	W mm
TR5452-22	7/8"	22.5	52	52

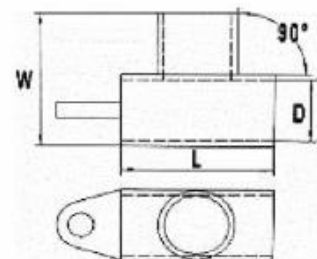

### AISI316 STAINLESS STEEL 90° 3-WAY TEE CONNECTOR

Code	Size	A mm	B mm	C mm
TR5454-22	7/8"	49.2	22.5	49.2
TR5454-25	1"	49	25.5	49
TR5454-30	1-1/5"	49	30.6	49
TR5454-32	1-1/4"	57	32.5	57

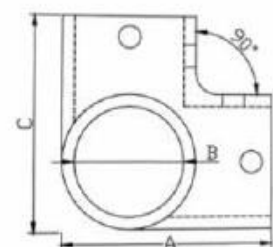



### AISI316 STAINLESS STEEL 90° 4-WAY TEE CONNECTOR

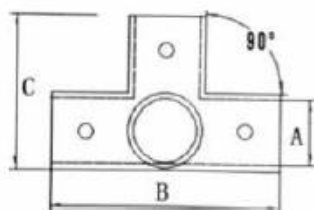

Code	Size	A mm	B mm	C mm
TR5454-22	7/8"	22.5	72.4	51
TR5454-25	1"	25.5	71.7	51.4

### AISI316 STAINLESS STEEL 90° CROSS TEE CONNECTOR

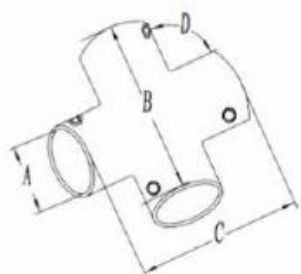

Code	Size	A mm	B mm	C mm
TR5455-22	7/8"	22.5	72.4	72.4
TR5455-25	1"	25.6	71.7	71.7
TR5455-30	1-1/5"	30.5	75	75

### AISI316 STAINLESS STEEL BOW FORM

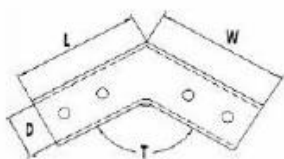

Code	Size	D	L	W	T
TR11022-11022	7/8"	22.5	63	63	110°
TR11025-11025	1"	25.6	63	63	110°
TR12022-12022	7/8"	22.7	64	64	120°
TR12025-12025	1"	25.6	64	64	120°
TR12522-12522	7/8"	22.7	64	64	125°
TR12525-12525	1"	25.6	64	64	125°
TR14022-14022	7/8"	22.5	59	59	140°
TR14025-14025	1"	25.6	59	59	140°

### AISI316 STAINLESS STEEL RAIL END

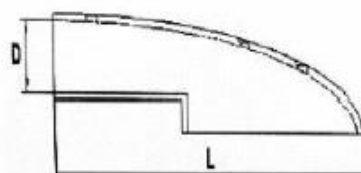

Code	Size	D mm	L mm
TR5470A-22	7/8"	22	119

**AISI316 STAINLESS STEEL RAIL END**

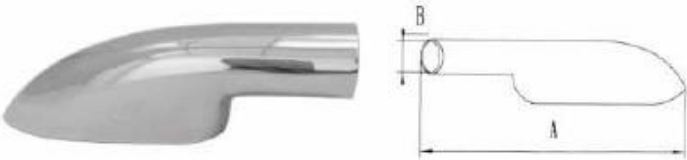

Code	Size	D mm	L mm
TR5471A-22	7/8"	22.5	175
TR5471B-25	1"	25.6	175

**AISI316 STAINLESS STEEL RAIL END**



Code	A mm	B mm
TR5473A-19	110	19.6

**AISI316 STAINLESS STEEL MAST BRACKET**

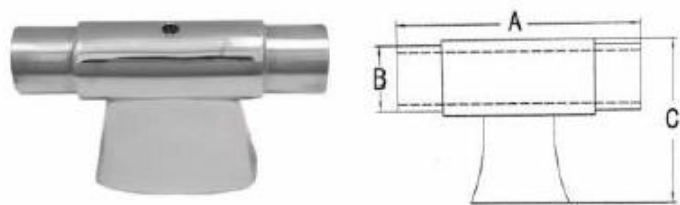

Code	A mm	B mm	C mm
TR5474A-25	100	25	61

**AISI316 STAINLESS STEEL STANCHION BASE**

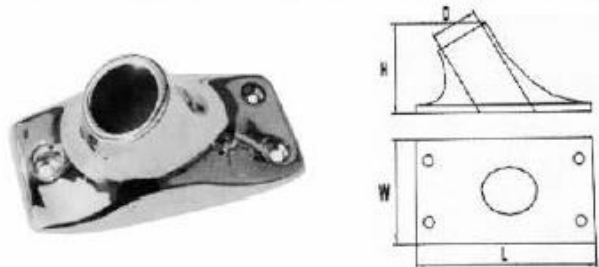

Code	D mm	L mm	W mm	H mm
TR5481A	14	85.6	40.5	33.2
TR5481B	20	86	42	44.4
TR5481C	25	90.5	45	52



# KAGI

TRADE SMARTER



## MARINE HARDWARE: Hinges



### AISI316 STAINLESS STEEL CASTING HINGE

Code	A mm	B mm
TR07638	76	38

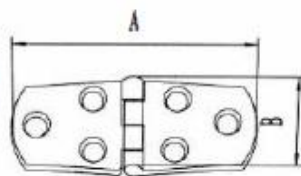

### AISI316 STAINLESS STEEL CASTING HINGE

Code	A mm	B mm
TR10238A	102	38
TR10738B	107	38

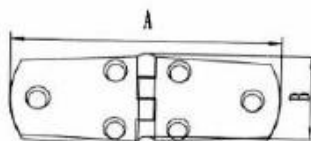

### AISI316 STAINLESS STEEL CASTING HINGE

Code	L mm	W mm
TR05738A	57	38
TR07638B	76	38

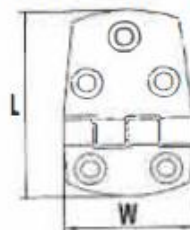



Code	A mm	B mm
TR4040A	40	40
TR5050B	50	50
TR7575C	75	75

### AISI316 STAINLESS STEEL CASTING HINGE

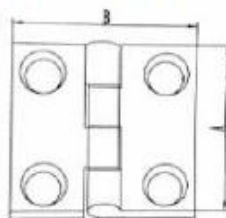

Code	L mm	W mm
TR5437A	54	37
TR7037B	70	37

### AISI316 STAINLESS STEEL CASTING HINGE

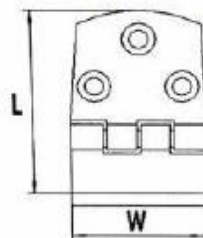

Code	L mm	W mm
TR6037A	60	37

### AISI316 STAINLESS STEEL CASTING HINGE

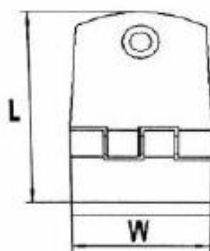

Code	A mm	B mm
TR17038	170	18

### AISI316 STAINLESS STEEL CASTING HINGE



### AISI316 STAINLESS STEEL CASTING HINGE

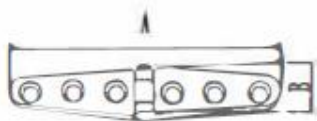

Code	A mm	B mm
TR15230	152	30

### AISI316 STAINLESS STEEL CASTING HINGE

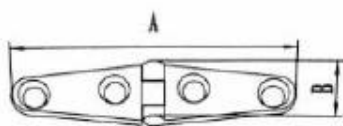

Code	A mm	B mm
TR10327	103	27

### AISI316 STAINLESS STEEL CASTING HINGE

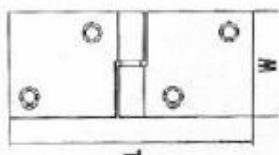

Code	L mm	W mm
TR9038L	90	38
TR9038R	90	38

### AISI316 STAINLESS STEEL CASTING HINGE

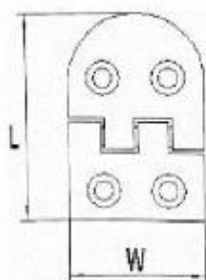

Code	L mm	W mm
TR7040A	70	40
TR8164A	81	64

**AISI316 STAINLESS STEEL CASTING HINGE**

Code	L mm	W mm
TR11038	110	38

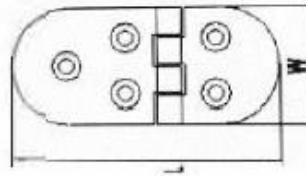

**AISI316 STAINLESS STEEL CASTING HINGE**

Code	L mm	W mm
TR07835A	78	35
TR17140B	171	40
TR18963C	189	63
TR22564D	225	64

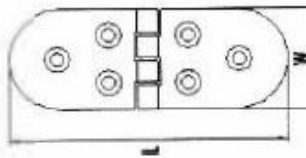

**AISI316 STAINLESS STEEL CASTING HINGE**

Code	L mm	W mm
TR14038A	140	38
TR14438B	147	38

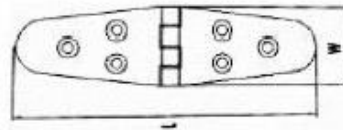

**AISI316 STAINLESS STEEL CASTING T-HINGE**

Code	L mm	W mm
TR10054A	100	54
TR15175B	151	75
TR20097C	200	97

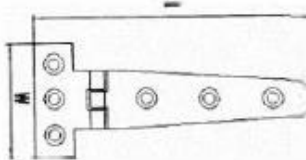



### AISI316 STAINLESS STEEL CASTING HINGE



Code	L mm	W mm
TR7638A	76	38

### AISI316 STAINLESS STEEL CASTING ROUND HINGE



Code	L mm	W mm
TR06565	65	65

### AISI316 STAINLESS STEEL CASTING HINGE

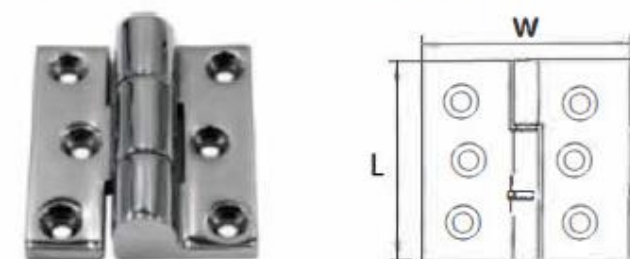

Code	L mm	W mm
TR08070A	80	70

### AISI316 STAINLESS STEEL CASTING HINGE



Code	L mm	W mm
TR10070A	100	70
TR12090B	120	90

**AISI316 STAINLESS STEEL CASTING HINGE**

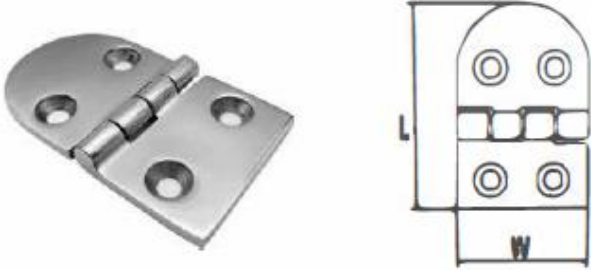

Code	L mm	W mm
TR07040A	70	40
TR08365B	83	65
TR10365C	103	65

**AISI316 STAINLESS STEEL CASTING HINGE**



Code	L mm	W mm
TR6629A	66	29

**AISI316 STAINLESS STEEL CASTING HINGE**



Code	L mm	W mm
TR20038A	200	38

**AISI316 STAINLESS STEEL CASTING HINGE**

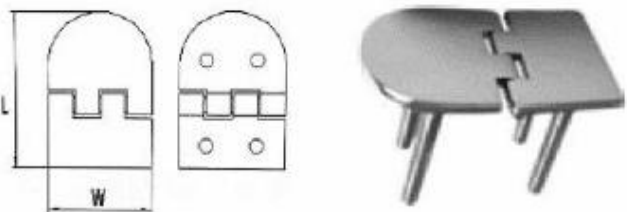

Code	L mm	W mm
TR09449A	94	49

### AISI316 STAINLESS STEEL CASTING HINGE

Code	L mm	W mm
TR8959A	89	59



### AISI316 STAINLESS STEEL CASTING HATCH HINGE

Code	A mm	B mm
TR7654A	76	54.3

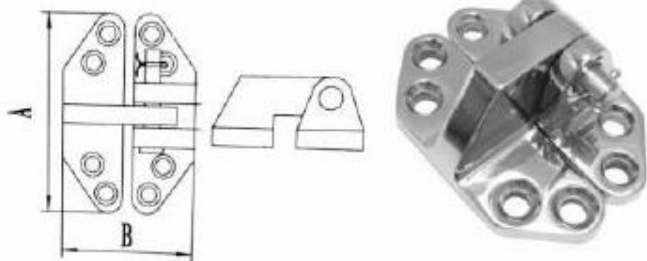

### AISI316 STAINLESS STEEL CASTING HATCH HINGE

Code	A mm	B mm
TR7665B	76	65.5



### AISI316 STAINLESS STEEL CASTING HATCH HINGE

Code	A mm	B mm
TR7165A	71	65.5

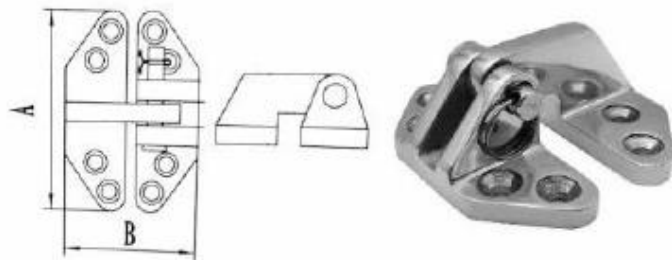





# KAGI

TRADE SMARTER



## MARINE HARDWARE: Pull Rings, Locks & Clamp Latches



### AISI316 STAINLESS STEEL SQUARE FLUSH LIFT RING

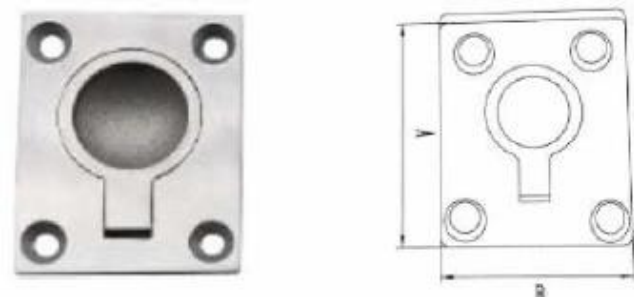

Code	A mm	B mm
TR04838A	48	38

### AISI316 STAINLESS STEEL SQUARE FLUSH LIFT RING

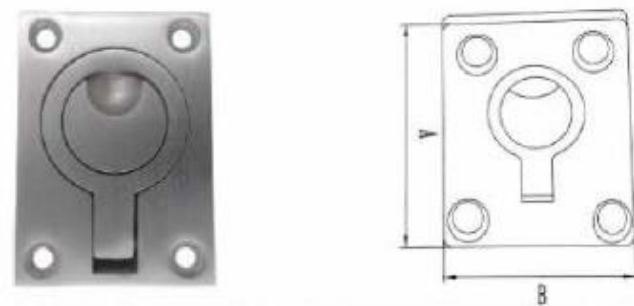

Code	A mm	B mm
TR6244B	62	44

### AISI316 STAINLESS STEEL ROUND FLUSH LIFT RING

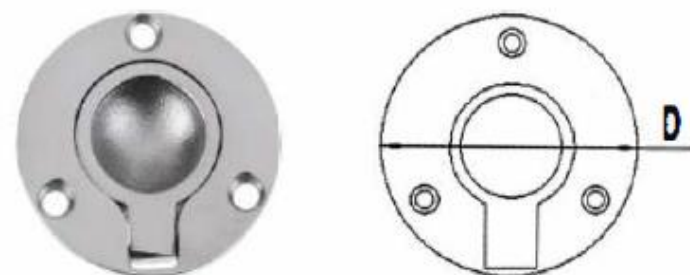

Code	D mm
TR05050A	50

### AISI316 STAINLESS STEEL SQUARE FLUSH LIFT RING WITH SPRING

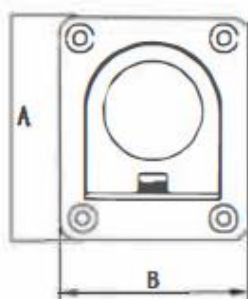

Code	A mm	B mm
TR4438A	44	38
TR65558	65	55

### AISI316 STAINLESS STEEL SQUARE FLUSH LIFT RING

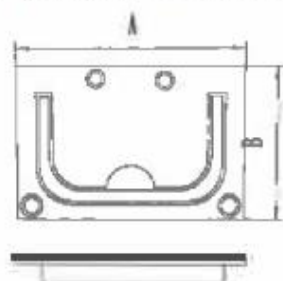
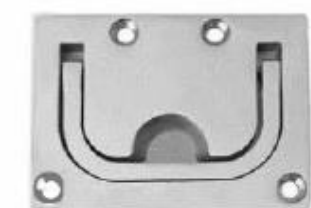

Code	A mm	B mm
TR7658A	76	58

### AISI316 STAINLESS STEEL TURNING LOCK

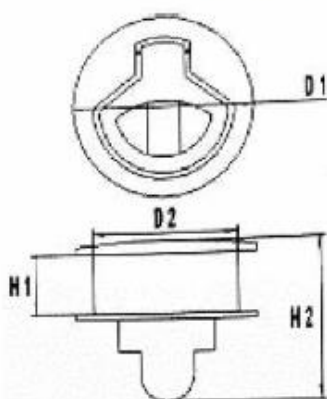

Code	D1 mm	D2 mm	H1 mm	H2mm
TR6250A	62	50.5	11.5	37.4

### AISI316 STAINLESS STEEL TURNING LOCK

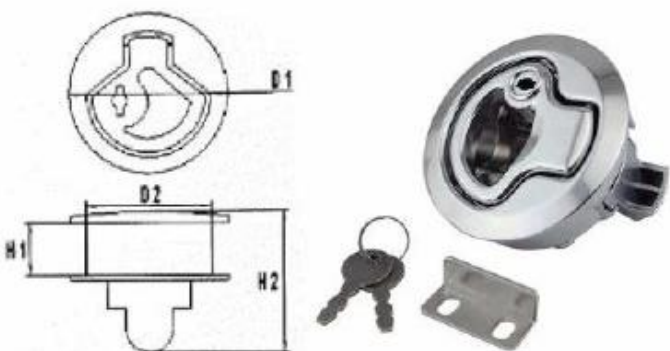

Code	D1 mm	D2mm	H1mm	H2mm
TR6250B	62	50.5	11.5	37.4

### AISI316 STAINLESS STEEL TURNING LOCK

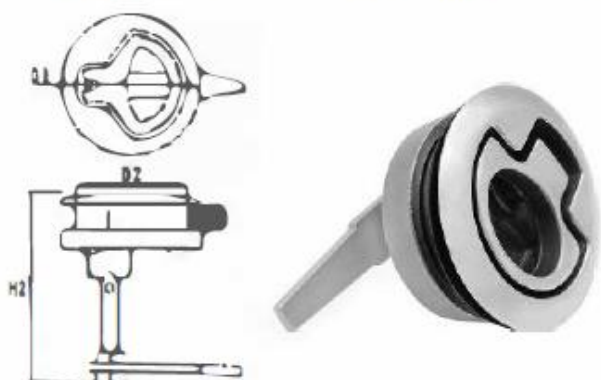

Code	D1 mm	D2mm	H1 mm	H2mm
TR6250C	62	50.5	11.5	69

### AISI316 STAINLESS STEEL TURNING LOCK

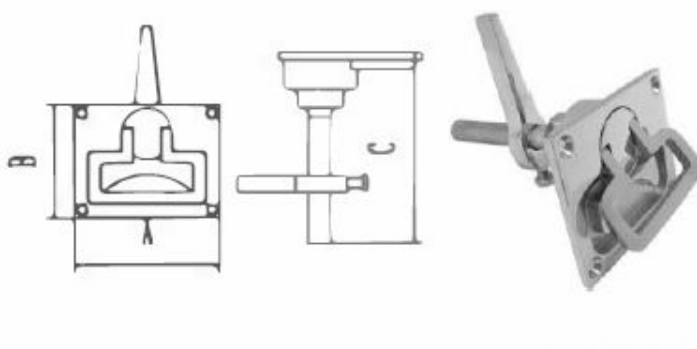

Code	A mm	Bmm	Cmm
TR7967A	79	67	109



**AISI316 STAINLESS STEEL TURNING LOCK**

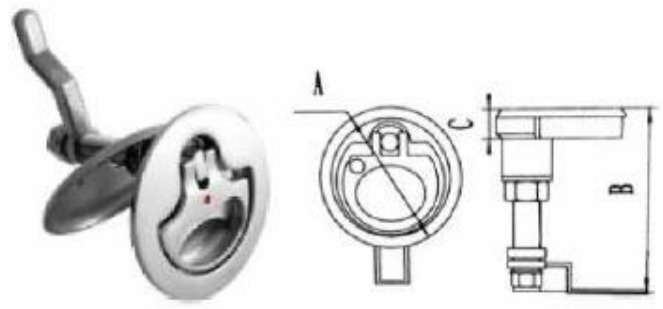

Code	A mm	B mm	C mm
TR6472A	64	72	13

**AISI316 STAINLESS STEEL TURNING LOCK**

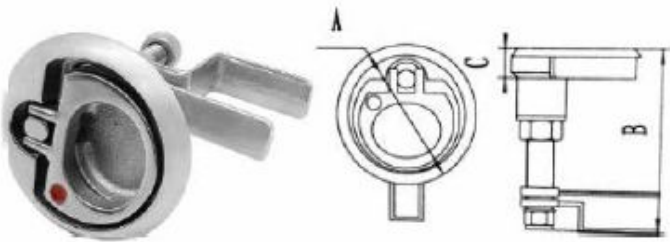

Code	A mm	B mm	C mm
TR6482A	64	82	15

**AISI316 STAINLESS STEEL FLUSH LIFT RING**

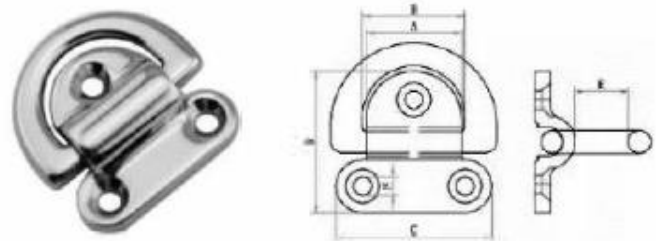

Code	A mm	Bmm	Cmm	Dmm
TR19006A	27	29	44	40
TR19008B	34	36	55	49.5
TR19010C	44	47.5	70	65

**AISI316 STAINLESS STEEL LOCKABLE CLAMP LATCH**



Code	L1 mm	L2mm	W1 mm	W2mm
TR11238A	112	39	50	50

### AISI316 STAINLESS STEEL LOCK LATCH

Code	L1mm	L2mm	W1mm	W2mm
TR8225A	82.5	25.4	27.8	28

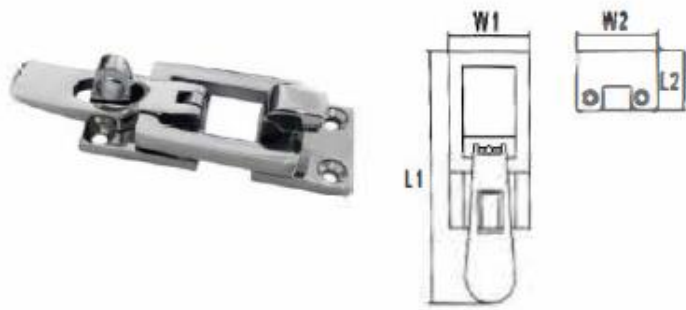

### AISI316 STAINLESS STEEL LOCK LATCH

Code	L1 mm	L2mm	W1mm	W2mm
TR8225B	82.5	25.4	27.8	28

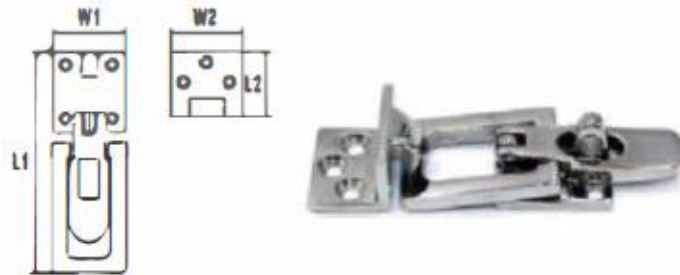

### AISI316 STAINLESS STEEL LOCK LATCH

Code	L mm	W mm
TR9039A	90	39
TR11039B	110	39

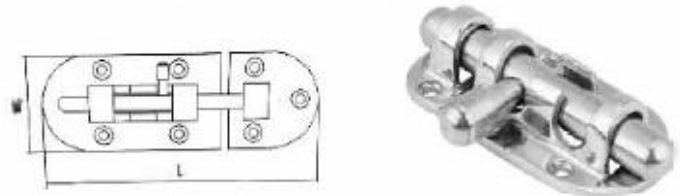

### AISI316 STAINLESS STEEL DOOR BUTTON

Code	D mm
TR4450A	42.5

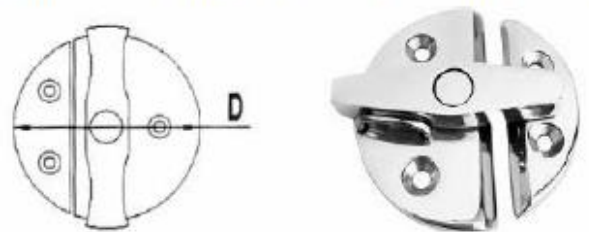



**KAGI**  
TRADE SMARTER



**MARINE HARDWARE:**  
Drain Plugs



**AISI316 STAINLESS STEEL DRAIN PLUG**

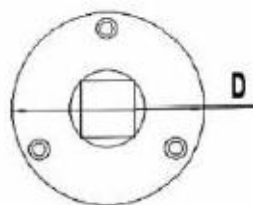

Code	D mm
TR05050B	50

**AISI316 STAINLESS STEEL DRAIN PLUG**

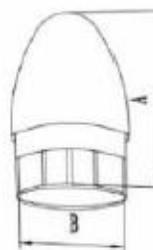

Code	B mm
TR5422A	22
TR5425A	25
TR5430A	30

**Stainless steel Diamond Garboard Drain Plug**

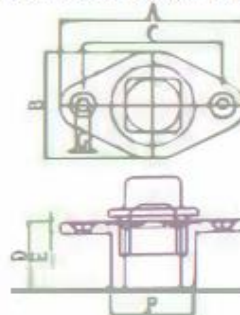

Code	A mm	B mm	C mm	D mm	F mm
TR19M24	70	41.5	52.5	25.5	31





## MARINE HARDWARE: Rod Holders



### AISI316 STAINLESS STEEL HEAVY FLUSH MOUNT ROD HOLDER



Code	Length	Liner I.D.	Degree
TR1030A-15	9 inch	1-5/8 inch	15°
TR1060B-30	9 inch	1-5/8 inch	30°
TR1090C-90	9 inch	1-5/8 inch	90°

### AISI316 STAINLESS STEEL FLUSH MOUNT ROD HOLDER



Code	Length	Liner I.D.	Degree
TR1130A-15	9 inch	1-5/8 inch	15°
TR1160A-30	9 inch	1-5/8 inch	30°
TR1190A-90	9 inch	1-5/8 inch	90°

### AISI316 STAINLESS STEEL FLUSH MOUNT ROD HOLDER



Code	Length	Liner I.D.	Degree
TR1130B-15	9 inch	1-5/8 inch	15°
TR1160B-30	9 inch	1-5/8 inch	30°
TR1190B-90	9 inch	1-5/8 inch	90°

### AISI316 STAINLESS STEEL FLUSH MOUNT ROD HOLDER

Code	Length	Liner I.D.	Degree
TR1230A-15	9 inch	1-5/8 inch	15°
TR1260A-30	9 inch	1-5/8 inch	30°
TR1290A-90	9 inch	1-5/8 inch	90°
NOTE	Rod holder with drain		



### AISI316 STAINLESS STEEL SLIDE MOUNT ROD HOLDER

Code	Length	Liner I.D.	Degree
TR1310A	10 inch	1-3/4 inch	90°



### AISI316 STAINLESS STEEL CLAMP-ON ADJUSTABLE FISHING ROD HOLDER

Code	Length	Liner I.D.	Tube L.
TR18290A-360	290mm	1-3/4 inch	8-1/2 inch
NOTE	360 Degree adjustable base		



### AISI316 STAINLESS STEEL CLAMP-ON ROD HOLDER

Code	Length	Liner I.D.	Pipe clamp
TR1409A	9 inch	1-5/8 inch	1inch-1-1/4 inch



### AISI316 STAINLESS STEEL CLAMP-ON ROD HOLDER

Code	Length	Liner I.D.	Pipe clamp
TR1509A	9 inch	1-5/8 inch	7/8inch-1 inch
TR1509B	9 inch	1-5/8 inch	1inch-1-1/4inch
TR1509C	9inch	1-5/8 inch	1-1/4inch-2 inch



### AISI316 STAINLESS STEEL CLAMP-ON ROD HOLDER

Code	Length	Liner I.D.	Pipe clamp
TR1609A	9 inch	1-5/8 inch	7/8inch-1 inch
TR1609B	9 inch	1-5/8 inch	1inch-1-1/4inch
TR1609C	9 inch	1-5/8 inch	1-1/4inch-2 inch



### AISI316 STAINLESS STEEL 3 FISHING CLAMP-ON ROD RACK

Code	Rod holder I.D.	length
TR2311A	1-5/8 inch(41.6mm)	11-1/2 inch



### AISI316 STAINLESS STEEL 4 FISHING CLAMP-ON ROD HOLDER

Code	Tube Length	Width Length
TR3016A	9 inch	16-1/4 inch





### AISI316 STAINLESS STEEL CLAMPON ADJUSTABLE ROD HOLDER



Code	For pie size	Rod holder I.D.
TR1943A	7/8 inch-1 inch	1-3/4 inch
TR1943B	1 inch-1 1/4 inch	1-3/4 inch
TR1943C	1-1/2 inch-1-5/8 inch	1-3/4 inch

### AISI316 STAINLESS STEEL CLAMPON ADJUSTABLE ROD HOLDER



Code	For pie size	Rod holder I.D.
TR20143A	3/4 inch	1-3/4 inch
TR20143B	1 inch	1-3/4 inch
TR20143C	1-1/4 inch	1-3/4 inch

### AISI316 STAINLESS STEEL CLAMP-ON ADJUSTABLE ROD HOLDER



Code	For pie size	Rod holder I.D.
TR22143A	7/8 inch	1-3/4 inch

### AISI316 STAINLESS STEEL CLAMP-ON ROD HOLDER



Code	Length	Liner I.D.	Tube L.
TR2302A	4inch*3/4inch	1-1/2 inch	8-1/2inch
NOTE	Adjustable For 1 inch Tube		

### AISI316 STAINLESS STEEL FLUSH MOUNT ROD HOLDER

Code	Length	Liner I.D.	Degree
TR2230A	8.3 inch	φ 44.5mm	30°
TR2290A	8.3 inch	φ 44.5mm	90°



### AISI316 STAINLESS STEEL CLAMP-ON ROD HOLDER

Code	Rod holder I.D.	length
TR3601A	1-1/2 inch	36-1/2 inch



### AISI316 STAINLESS STEEL OUTRIGGER ROD HOLDER

Code	I.D.	length	Pipe length
TR2230A	1-1/2 inch	11-1/2 inch	19-1/2 inch



### AISI316 STAINLESS STEEL CLAMP-ON ROD HOLDER

Code	I.D.	length	Pipe length
TR2240A	1-1/2 inch	11-1/2 inch	19-1/2 inch



### AISI316 STAINLESS STEEL CLAMP-ON ROD HOLDER



Code	Size	Length	Tube L.
TR3381A-25	1"	6.8 inch	25mm
TR3382B-32	1-1/4"	6.8 inch	32mm

### AISI316 STAINLESS STEEL CLAMP-ON ROD HOLDER



Code	Length	Width	Base
TR2472A	16.3 inch	10 inch	4.72inch*2.7inch

### AISI316 STAINLESS STEEL 5 TUBE ADJUSTABLE ROD HOLDER



Code	Width	Rod holder Length
TR4058A	1-1/2inch-1-5/8inch	10inch

### AISI316 STAINLESS STEEL CLAMP-ON ROD HOLDER



Code	Rod holder I.D.	Length
TR3412A	1-3/4 inch	12-1/4 inch





# KAGI

TRADE SMARTER



## MARINE HARDWARE: Thru-hulls Plugs



### THROUGH HULL OUTLET WITH HOSE CONNECTION

Code	D1 mm	D2 mm	H mm
TR1201A	1/2 inch	14	87
TR1202A	3/4 inch	18	96
TR1203A	1 inch	24.5	95.5
TR1204A	1-1/4 inch	32	87
TR1205A	1-1/2 inch	38	97

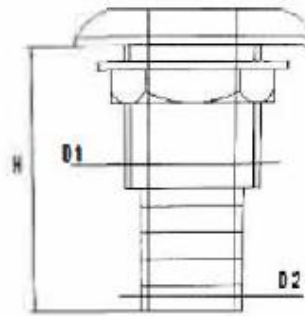

### THRU-HULL WITH HOSE

Code	SIZE	D1 mm	D2 mm	H mm
TR1101B	1/2 inch	16.5	14	53
TR1102B	3/4 inch	21	18.5	61
TR1103B	7/8 inch	26	23	70
TR1104B	1 inch	33	26	72
TR1105B	1-1/4 inch	42	33.5	78
TR1106B	1-1/2 inch	42	39.5	79
TR1107B	1-3/4 inch	49	46	85
TR1108B	2 inch	59	52	98

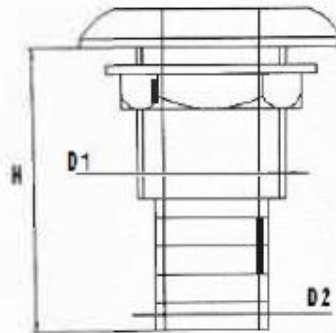



## MARINE HARDWARE: Drain Cockpits



### AISI316 STAINLESS STEEL COCKPIT

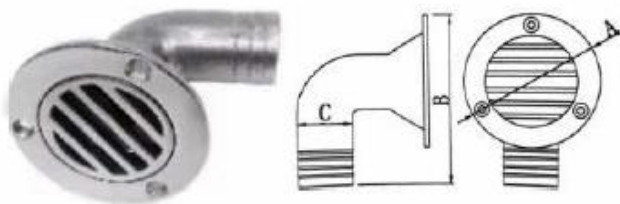

Code	Size	Amm	B mm	C mm
TR1401A-32	32MM	79	103	32.5
TR1402A-38	38MM	79	103	38.5

### AISI316 STAINLESS STEEL COCKPIT DRAIN

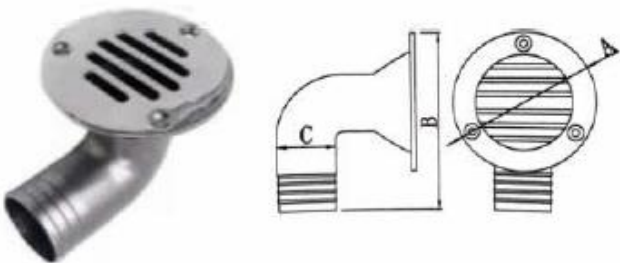

Code	Size	A mm	B mm	C mm
TR1501A-32	32MM	79	103	32.5
TR1502A-38	38MM	79	103	38.5

### AISI316 STAINLESS STEEL COCKPIT DRAIN

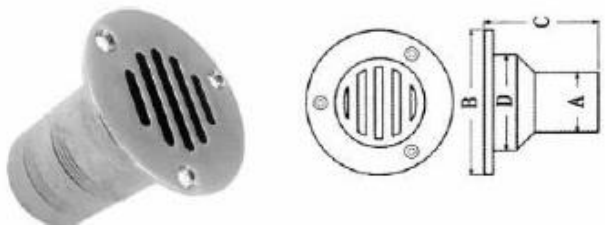

Code	Size	A mm	B mm	C mm
TR1601A-50	2"	51	82	80



### AISI316 STAINLESS STEEL INTAKE STRAINER

Code	Size	A	B	C	D	E
TR1801	3/8 inch	90	82	16.5	11	65
TR1802	1/2 inch	90	82	21	12.5	66
TR1803	3/4 inch	107	104	26	18.5	80
TR1804	1 inch	106	106	33	25.5	76
TR1805	1-1/4 inch	103	117	42	32	78
TR1806	1-1/2 inch	109	133	47.5	38	80
TR1807	2 inch	124	152	60	50	91
TR1808	2-1/2 inch	153	198	75	63.5	112
TR1809	3 inch	178	240	88	76	130

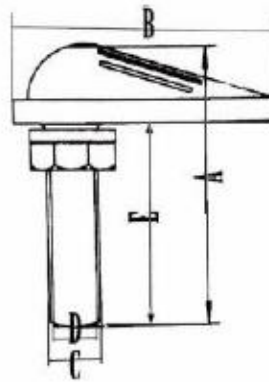

### AISI316 STAINLESS STEEL TANK VENT

Code	D mm	H1 mm	H2 mm	H3 mm
TR2880A	16	82	28	70

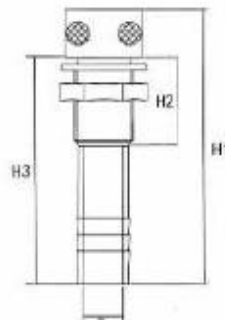

### AISI316 STAINLESS STEEL 90 DEGREE TANK VENT

Code	D mm	H1 mm	H2 mm	H3 mm
TR2880B	16	84	28	49

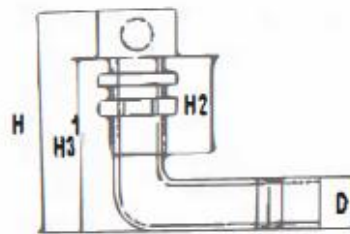

### AISI316 STAINLESS STEEL TANK VENT

Code	D mm	H1 mm	H2 mm	H3 mm
TR2881A	16	84	28	70

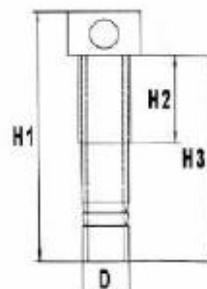





**KAGI**  
TRADE SMARTER



# MARINE HARDWARE: Deck Fillers



## AISI316 STAINLESS STEEL DECK FILLER

(WITH KEYLESS CAP)

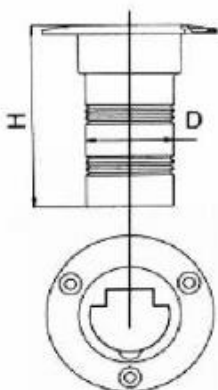

Code	Model	D mm	H mm
TR1038-FUEL	FUEL	38	80
TR1050-FUEL	FUEL	50	80
TR1138-DIESEL	DIESEL	38	80
TR1150-DIESEL	DIESEL	50	80
TR1238-WASTE	WASTE	38	80
TR1250-WASTE	WASTE	50	80
TR1338-GAS	GAS	38	80
TR1350-GAS	GAS	50	80
TR1438-WATER	WATER	38	80
TR1450-WATER	WATER	50	80

## AISI316 STAINLESS STEEL DECK FILLER

(WITH KEY)

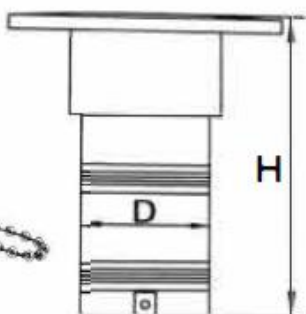

Code	Model	D mm	H mm
TR2038-FUEL	FUEL	38	80
TR2050-FUEL	FUEL	50	80
TR2138-DIESEL	DIESEL	38	80
TR2150-DIESEL	DIESEL	50	80
TR2238-WASTE	WASTE	38	80
TR2250-WASTE	WASTE	50	80
TR2338-GAS	GAS	38	80
TR2350-GAS	GAS	50	80
TR2438-WATER	WATER	38	80
TR2450-WATER	WATER	50	80

### AISI316 STAINLESS STEEL DECK FILLER

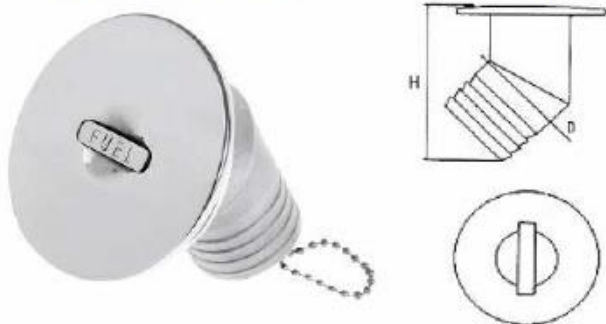

Code	Model	D mm	H mm
TR3038-FUEL	FUEL	38	78
TR3050-FUEL	FUEL	50	97
TR3138-DIESEL	DIESEL	38	78
TR3150-DIESEL	DIESEL	50	97
TR3238-WASTE	WASTE	38	78
TR3250-WASTE	WASTE	50	97
TR3438-WATER	WATER	38	78
TR3450-WATER	WATER	50	97

### AISI316 STAINLESS STEEL DECK FILLER

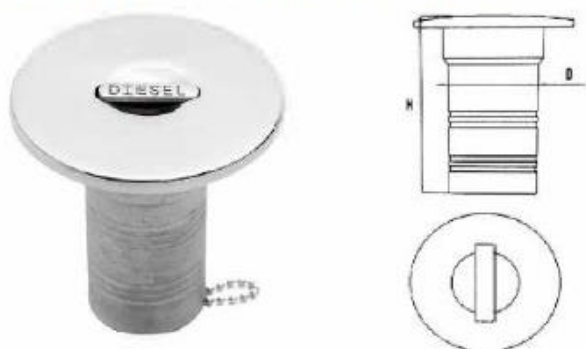

Code	Model	D mm	H mm
TR4038-FUEL	FUEL	38	87.1
TR4050-FUEL	FUEL	50	87.1
TR4138-DIESEL	DIESEL	38	87.1
TR4150-DIESEL	DIESEL	50	87.1
TR4238-WASTE	WASTE	38	87.1
TR4250-WASTE	WASTE	50	87.1
TR4438-WATER	WATER	38	87.1
TR4450-WATER	WATER	50	87.1

### AISI316 STAINLESS STEEL DECK FILLER

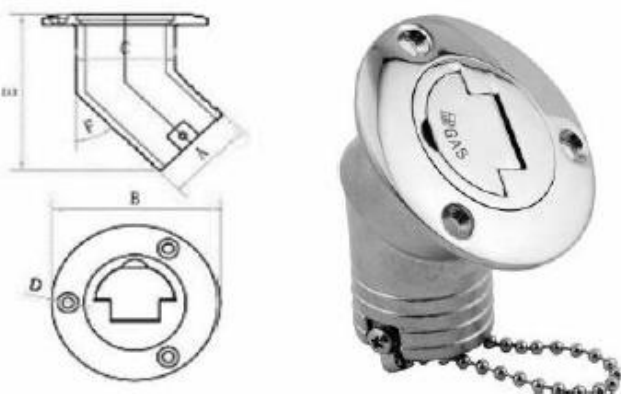

Code	Model	A mm	H mm
TR5038-FUEL	FUEL	38	76
TR5050-FUEL	FUEL	50	91
TR5138-DIESEL	DIESEL	38	76
TR5150-DIESEL	DIESEL	50	91
TR5238-WASTE	WASTE	38	76
TR5250-WASTE	WASTE	50	91
TR5338-WATER	WATER	38	76
TR5350-WATER	WATER	50	91
TR5438-GAS	GAS	38	76
TR5450-GAS	GAS	50	91



### PLASTIC DECK FILLER SOCKET OF WATER

Code	A mm	B mm	C mm	D mm	E mm
TR0605-WATER	85	70	34	38	50
SIZE	1-1/2 INCH				



### PLASTIC DECK FILLER SOCKET OF FUEL

Code	A mm	B mm	C mm	D mm	E mm
TR0604-FUEL	85	70	34	38	50
SIZE	1-1/2 INCH				



### PLASTIC THRU-HULL OUTLET

Code	SIZE	A mm	B mm	C mm	D mm	E mm
TR0620-16	5/8 inch	73.5	42	17	23	16
TR0620-20	3/4 inch	80	50.5	19	26.5	18.5
TR0620-25	1 inch	93	61	26	33	25
TR0620-32	1-1/4 inch	97	67	33	41	31.5
TR0620-38	1-1/2 inch	102	75	37	46.5	38
TR0620-50	2 inch	130	90	49	57	51



### PLASTIC WATER FILL HATCH INLET FILLER

Code	Colour	A (cm)	Material
TR2930-W	White	11*11*8	Food grade plastic PP
TR2930-BK	Black	11*11*8	Food grade plastic PP





### GRAVITY WATER INLET WITH LOCK KEY



Code	Colour	A (cm)	Material
TR3130-W	White	12*12*9.2	Food grade plastic PP

### GRAVITY WATER INLET WITH LOCK KEY



Code	Colour	A(cm)	Material
TR4060-W	White	11*11*8	Food grade plastic PP
80 mm (hole to hole), 38 mm (pipe's inner diameter)			

### ABS DECK INSPECTION PLATE

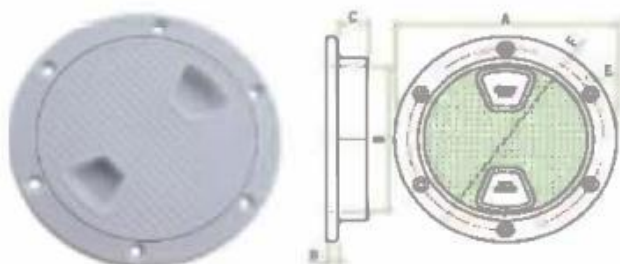

Code	SIZE	A	B	C	D	F
TR1301-4	4 inch	143	101	19	7.5	126
TR1301-6	6 inch	198	151	16.5	8.5	179
TR1301-8	8 inch	250	180	19	9.5	230

### Plastic Round Deck Hatch



Code	SIZE
TR1302-50 With lock	<ul style="list-style-type: none"> <li>- Material: Nylon Plastic</li> <li>- With lock</li> <li>- Color: Black</li> <li>- Diameter: 2.4"</li> <li>- Cutout size: 2" (50mm)</li> </ul>
TR1303-50 Without lock	<ul style="list-style-type: none"> <li>- Material: Nylon Plastic</li> <li>- Without lock</li> <li>- Color: Black</li> <li>- Diameter: 2.4"</li> <li>- Cutout size: 2" (50mm)</li> </ul>



# KAGI

TRADE SMARTER



## MARINE HARDWARE: General Hardware



### AISI316 STAINLESS STEEL DECK PLATE

Code	Size	D1 mm	D2 mm
TR3103A	3 inch	123	81.8
TR3104A	4 inch	147	106
TR3105A	5 inch	173	133
TR3106A	6 inch	196.5	161.8

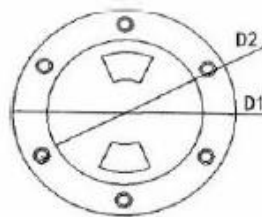

### AISI316 STAINLESS STEEL DECK PLATE

Code	SIZE	D1 mm	D2 mm
TR3203B	3 inch	123	81.8
TR3204B	4 inch	147	106
TR3205B	5 inch	173	133
TR3206B	6 inch	196.5	161.8

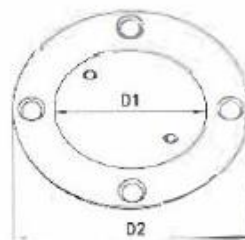

### AISI316 STAINLESS STEEL FOLDING STEP

Code	L mm	W mm
TR12043A	120	43

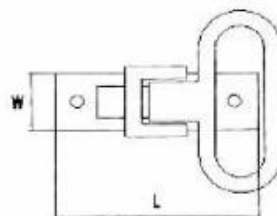

### AISI316 STAINLESS STEEL FOLDING STEP

Code	A mm	C mm
TR10837B	108	37
TR10845B	108	45
TR14045B	140	45

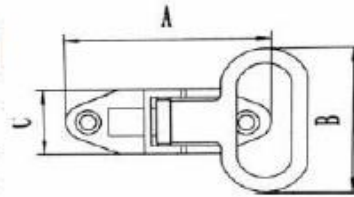

### AISI316 STAINLESS STEEL BOAT HOOK

Code	A mm	D mm
TR17034A	170	28
TR19041A	190	34
TR19038B	190	37

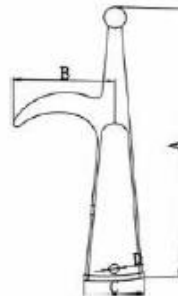

### AISI316 STAINLESS STEEL BIMINI TOP HANDRAIL

Code	Diameter
TR17034A	22mm
TR19041A	25mm



### Stainless steel Round Air Louver Vent(Slide Khob Opening)

Code	Size	A mm	B mm	C mm	D mm
TR1702-5	5inch	125	81.5	3.5	3







# KAGI

TRADE SMARTER



## MARINE HARDWARE: Rigging Hardware



Wire Eye Strap

Code	A mm	B mm	C mm	D mm	E mm	G mm
TR1602-4	4mm	40	11	1.7	7	32
TR1602-5	5mm	50	13	2.0	9	44
TR1602-6	6mm	58	16	2.5	10	44
TR1602-8	8mm	63	17	3.6	13	47
TR1602-10	10mm	77	22	4.6	16.5	51

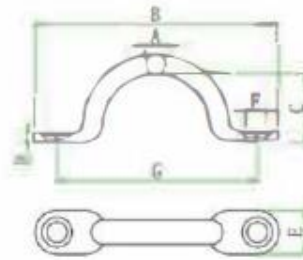

Diamond Eye Plate

Code	Size	A mm	B mm	C mm	D mm	E mm
TR6301-5	5mm	36	60	21	2.5	14
TR6301-6	6mm	40	65	26	2.5	16
TR6301-8	8mm	50	80	32	3	20
TR6301-10	10mm	60	100	38	3	26

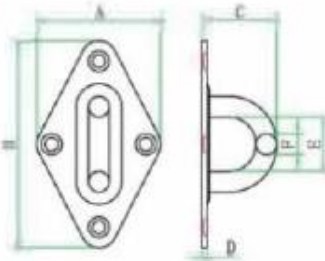

Square Eye Plate

Code	Size	A mm	B mm	C mm	D mm	E mm
TR6302-5	5mm	30	35	21	2.5	14
TR6302-6	6mm	35	40	26	2.5	16
TR6302-8	10mm	40	50	32	3	20

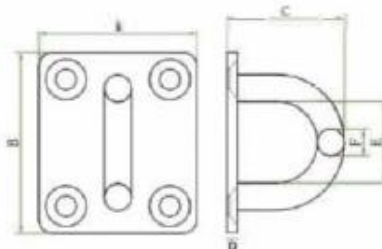

### Round Eye Plate

Code	Size	A mm	C mm	D mm	E mm	F mm
TR6303-5	5mm	33	21	2.5	14	5
TR6303-6	6mm	40	26	2.5	16	6
TR6303-8	8mm	50	32	3.0	20	8

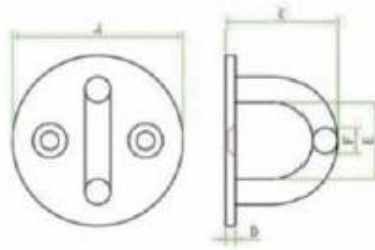

### Oblong Eye Plate

Code	Size	A mm	B mm	C mm	D mm	E mm
TR6304-5	5mm	15	45	21	2.5	14
TR6304-6	6mm	20	60	26	2.5	16
TR6304-8	8mm	25	80	32	3.0	20

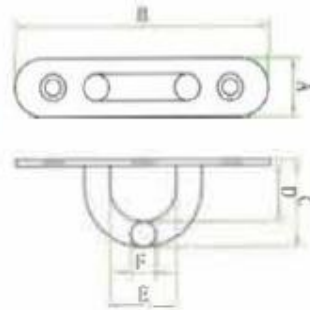

### Diamond Eye Plate With Ring

Code	Size	A	B	C	D	E	F	L
TR6305-5	5mm	36	60	21	2.5	14	5	30
TR6305-6	6mm	40	65	26	2.5	16	6	35
TR6305-8	8mm	50	80	32	3.0	20	8	45
TR6305-10	10mm	60	100	38	3.0	26	10	50

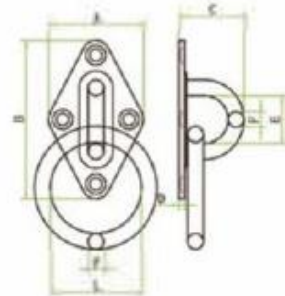

### Square Eye Plate With Ring

Code	Size	A	B	C	D	E	F	L
TR6306-5	5mm	30	35	21	2.5	14	5	30
TR6306-6	6mm	35	40	26	2.5	16	6	35
TR6306-8	8mm	40	50	32	3.0	20	8	45

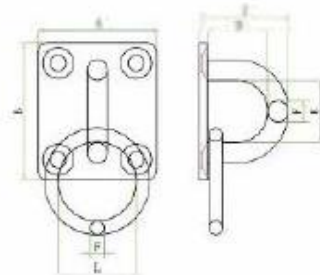



**Round Eye Plate With Ring**



Code	Size	A	C	D	E	F	L
TR6307-5	5mm	33	21	2.5	14	5	30
TR6307-6	6mm	40	26	2.5	16	6	35
TR6307-8	8mm	50	32	3.0	20	8	45

**Oblong Eye Plate With Ring**

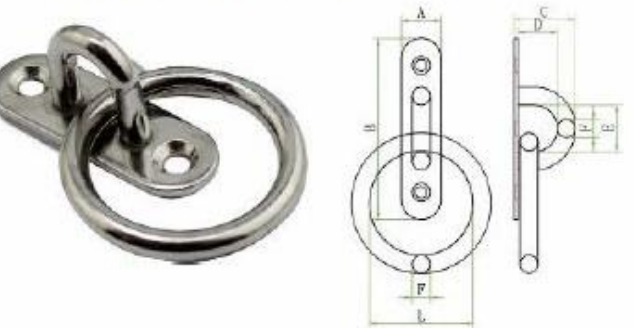

Code	Size	A	B	C	D	E	F	L
TR6308-5	5mm	15	45	21	2.5	14	5	30
TR6308-6	6mm	20	60	26	2.5	16	6	35
TR6308-8	8mm	25	80	32	3.0	20	8	45

**Wire Rope Cleat**



Code	Size	A	B	C	D	Wight/kg
TR0204-4	4 inch	112	21	21	5	0.036
TR0204-6	6 inch	151	28	28	7	0.076

**Fixed Eye Snap Shackle**

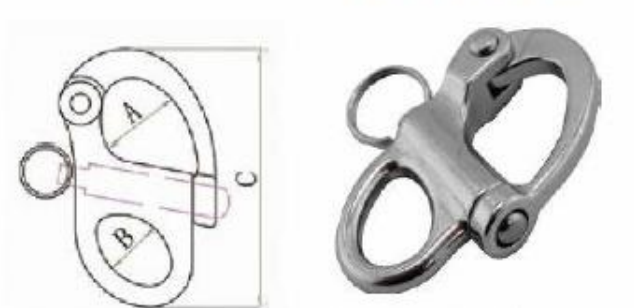

Code	Size	A	B	C	WLL/kg	WT/kg
TR6401-35	35MM	12.5	7.5	35	100	0.013
TR6401-52	52MM	18	11	52	450	0.043
TR6401-69	69MM	20	15	70	660	0.082
TR6401-96	96MM	27	18.5	96	950	0.212



### Swivel Eye Snap Shackle

Code	Size	A	B	C	WLL/kg	WT/kg
TR6402-70	70MM	18	12.5	71	450	0.061
TR6402-87	87MM	20	16.5	89	650	0.115
TR6402-128	128MM	27	24	128	950	0.291

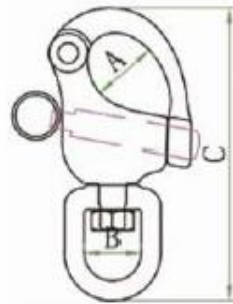

### Swivel Jaw Snap Shackle

Code	Size	A	B	C	WLL/kg	WT/kg
TR6403-70	70MM	18	10	70	450	0.067
TR6403-87	87MM	20	12.5	91	650	0.138
TR6403-128	128MM	27	21	128	950	0.342

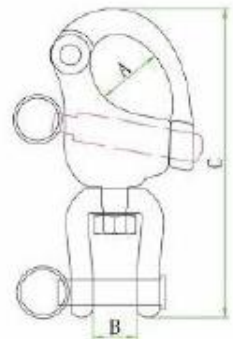

### Swivel Jaw Snap Shackle

Code	Size	A	B	C	WLL/kg	WT/kg
TR6404-20	20*65	14	21	65	270	0.041
TR6404-25	25*76	15	26	76	340	0.071

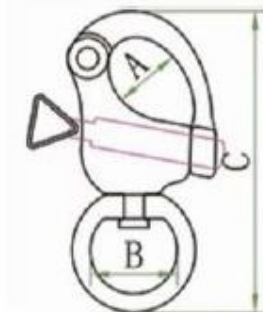

### Key Pin Shackle

Code	Size	A	B	C	WLL/kg	WT/kg
TR6406-5	5mm	13	40	5	100	0.029
TR6406-6	6mm	15	42	6	150	0.051
TR6406-8	8mm	21.5	61	8	250	0.111

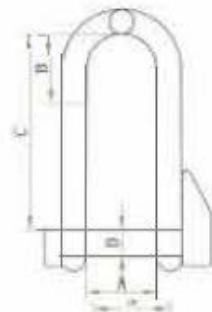

## Key Pin Shackle With Bar

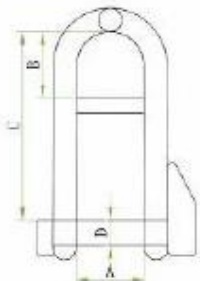

Code	Size	A	B	C	D	WLL/kg	WT/kg
TR6407-5	5mm	13	12.5	40	5	100	0.035
TR6406-6	6mm	15	15	42	6	150	0.062
TR6406-8	8mm	21.5	26	61	8	250	0.122

## Long D Shackle



Code	Size	B	C	D	E	WLL/kg	WT/kg
TR6411-4	4mm	8	30	4	24	70	0.015
TR6411-5	5mm	10	37.5	5	30	140	0.018
TR6411-6	6mm	12	45	6	35	230	0.031
TR6411-8	8mm	16	60	8	43.5	340	0.077
TR6411-10	10mm	20	75	10	56	700	0.157
TR6411-12	12mm	24	90	12	66	1200	0.251

## EU Type D Shackle

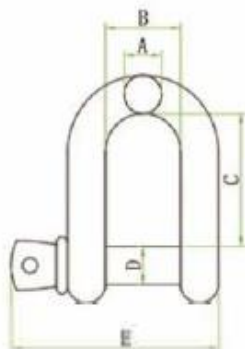

Code	Size	B	C	D	E	WLL/kg	WT/kg
TR6409-4	4mm	8	16	4	24	60	0.008
TR6409-5	5mm	10	20	5	30	80	0.016
TR6409-6	6mm	12	24	6	35	100	0.025
TR6409-8	8mm	16	32	8	43.5	200	0.059
TR6409-10	10mm	20	40	10	56	320	0.115
TR6409-12	12mm	24	48	12	66	520	0.198
TR6409-14	14mm	28	56	14	75.5	700	0.306
TR6409-16	16mm	32	64	16	88	800	0.461
TR6409-18	18mm	36	72	18	99.5	950	0.672
TR6409-20	20mm	40	80	20	109	1100	0.875
TR6409-22	22mm	44	90	22	120	1500	1.257
TR6409-24	24mm	50	96	24	135	2100	1.655
TR6409-28	28mm	56	112	28	148	3000	2.496

## Twisted Shackle

Code	Size	B	C	D	E	WLL/kg	WT/kg
TR6412-4	4mm	4	4	8	22	99	0.015
TR6412-5	5mm	5	5	10	27.5	120	0.018
TR6412-6	6mm	6	6	12	33	175	0.031
TR6412-8	8mm	8	8	16	44	300	0.077
TR6412-10	10mm	10	10	20	55	580	0.157
TR6412-12	12mm	12	12	24	66	700	0.251

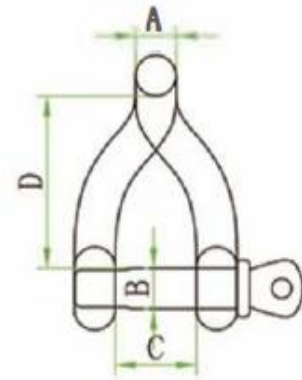

## G209 US Bow Shackle

Code	Size	A	B	C	D	WLL/kg	WT/kg
TR6414-5	3/16"*6	4.8	9.5	22	6	350	0.02
TR6414-6	1/4"*8	6.2	11.5	28.5	7.8	500	0.038
TR6414-8	1/16"*10	8	13	30.5	9	750	0.073
TR6414-10	3/8"*12	9.3	16.5	36.5	11	1000	0.138
TR6414-11	7/16"*14	11	19	42.5	12.5	1500	0.19
TR6414-12	1/2"*16	12.5	20	47.5	15.5	2000	0.31
TR6414-16	5/8"*20	15.8	26.5	60	19	3250	0.62
TR6414-20	3/4"*22	19	31.5	71	22	4750	0.97
TR6414-22	7/8"*24	22	36.5	84	25	6500	1.37
TR6414-25	1"*28	25.2	42.6	95	28	8500	2.08

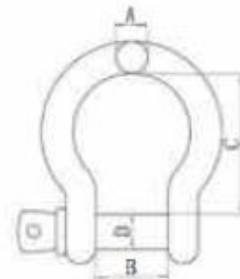

Code	Size	A	B	C	D	WLL/kg	WT/kg
TR6501-4	4mm	48	11.8	9.8	3.8	80	0.02
TR6501-5	5mm	60	13.8	14.5	4.8	100	0.034
TR6501-6	6mm	68	15.8	16.8	5.5	150	0.048
TR6501-8	8mm	88	20	21	7.4	300	0.111
TR6501-10	10mm	107	23	26	9.3	500	0.202
TR6501-12	12mm	122	25.5	27	11.2	1000	0.325
TR6501-14	14mm	145	31.8	33.2	13	1200	0.518
TR6501-16	16mm	175	38	44	15	1500	0.81
TR6501-20	20mm	203	44	47.8	18.8	2100	1.48

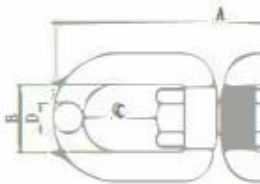

## Eye&Eye End Swivel





### Eye & Jaw End Swivel

Code	Size	A	B	C	D	WLL/kg	WT/kg
TR6502-4	4mm	50	118	9.8	3.8	80	0.022
TR6502-5	5mm	60	13.8	14.5	4.8	100	0.038
TR6502-6	6mm	66.5	15.8	16.8	5.5	150	0.056
TR6502-8	8mm	88	20	21	7.4	300	0.129
TR6502-10	10mm	106	23	26	9.3	500	0.238
TR6502-12	12mm	124	25.5	27	11.2	1000	0.372
TR6502-14	14mm	145	31.8	33.2	13	1200	0.6
TR6502-16	16mm	179	38	44	15	1500	0.94
TR6502-20	20mm	203	44	47.8	18.8	2100	1.71

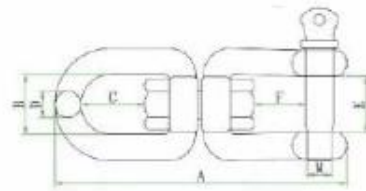

### Eye & Jaw End Swivel

Code	Size	A	B	C	D	WLL/kg	WT/kg
TR6503-4	4mm	51	8	10.5	3.8	80	0.025
TR6503-5	5mm	60	10	11	4.8	100	0.041
TR6503-6	6mm	66.5	12	11.5	5.8	150	0.062
TR6503-8	8mm	88.5	16	17	7.8	300	0.144
TR6503-10	10mm	106	20	19	9.8	500	0.281
TR6503-12	12mm	124	24	22	11.8	1000	0.438
TR6503-14	14mm	143	28	26	13.8	1200	0.671
TR6503-16	16mm	182	32	38	15.8	1500	1.071
TR6503-20	20mm	205	40	38	19.8	2100	1.828

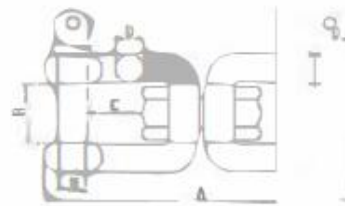

### Quick Release Hook

Code	Size	A	B	C	D	E	F	WT/kg
TR6109-4	4"	100	20	10	9	45	23	0.09

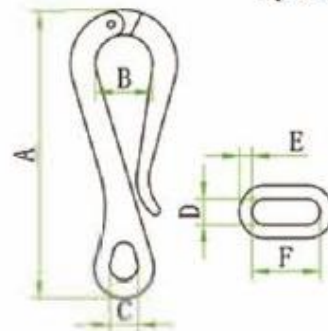

## Swivel Eye Crane Hook

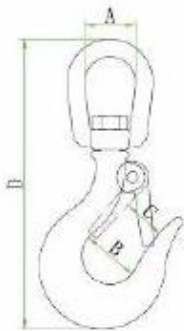

Code	Size	A	B	C	WLL/kg	WT/kg
TR6102-150	3/16inch	15.8	17.6	11	150	0.082
TR6102-350	1/4inch	22	23.9	16.9	350	0.155
TR6102-650	5/16inch	27	26.7	20.5	650	0.237
TR6102-1000	3/8inch	28.5	32.8	23.5	1000	0.436
TR6102-1500	1/2inch	36	37.8	31	1500	0.711

## Large Eye Crane Hook



Code	Size	A	B	C	WLL/kg	WT/kg
TR6101-0.2	0.2T	18	92	18	200	0.091
TR6101-0.3	0.3T	19	102	17	300	0.127
TR6101-0.5	0.5T	28	119	17	500	0.210

## Swivel Jaw Crane Hook

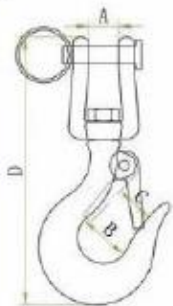

Code	Size	A	B	C	D	WLL/kg	WT/kg
TR6103-150	3/16"	9.5	17.6	11	90	150	0.09
TR6103-650	1/4"	12.5	24	16.9	114	350	0.167
TR6103-650	5/16"	15	26	20.5	138	650	0.259
TR6103-1000	3/8"	17.5	32.8	23	158	1000	0.456
TR6103-1500	1/2"	36	36	31	190	1500	0.748

## Swivel Jaw Crane Hook



Code	Size	A	B	C	D	WLL/kg	WT/kg
TR6104-0.5	0.5T	16.5	90	16	8	500	0.144
TR6104-0.75	0.75T	18.5	101.5	18.5	9	750	0.204
TR6104-1	1.0T	23	114.5	21	11	1000	0.286
TR6104-1.5	1.5T	28	129.5	21.5	12	1500	0.418
TR6104-2	2.0T	32	153	26	15	2000	0.656
TR6104-3	3.0T	38	182.5	31.5	17.5	3000	1.257

## Crane Hook with Latch

Code	Size	A	B	C	D	WT/kg
TR6105-0.5	1/4"	99	22	14.5	11.5	0.218
TR6105-0.5	5/16"	113.5	25	18.5	12.5	0.328
TR6105-0.5	3/8"	129.5	28	22	14.5	0.468
TR6105-1.5	1/2"	155.5	33.5	27	16.5	0.778

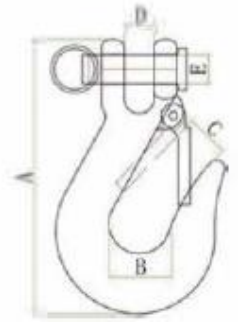

## Quick Release Hook

Code	Size	A	B	C	D	E	F	WT/kg
TR6109-4	4"	100	20	10	9	45	23	0.09

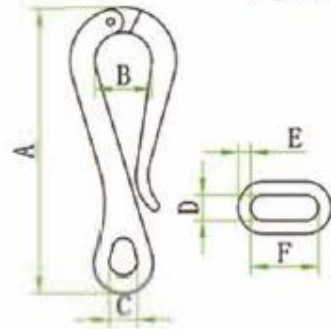

## Oval Swivel Snap Hook

Code	Size	A	B	C	D	WLL/kg	WT/kg
TR6201-1	1#(3/8"×65)	11.5	3.5	9	65	30	0.022
TR6201-2	2#(1/2"×72)	13.5	4	9.5	72	50	0.029
TR6201-3	3#(5/8"×82)	17.5	4.5	10	82	100	0.042
TR6201-4	4#(3/8"×85)	21.5	5	11.5	91	120	0.048
TR6201-5	1#(3/8"×85)	26.5	5.5	12	100	150	0.062
TR6201-6	1#(3/8"×85)	34	6	14	126	180	0.099

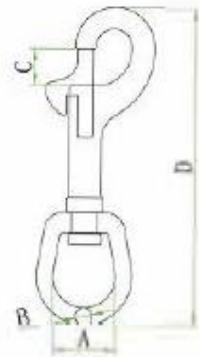

## Round Ring Swivel Snap Hook

Code	Size	A	B	C	D	WLL/kg	WT/kg
TR6202-1	1#(1/2"×63)	14.5	3.5	9	63	30	0.022
TR6202-2	2#(5/8"×71)	17.5	4	9.5	71	50	0.029
TR6202-3	3#(3/4"×81)	22	4.5	10	81	100	0.042
TR6202-4	4#(1"×90)	26	5	11	90	120	0.048
TR6202-5	5#(1-1/8"×97)	29	5.5	12	97	150	0.061
TR6202-6	6#(1-1/4"×119)	34.5	6	14	119	180	0.095

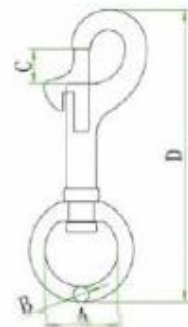



### Square Ring Swivel Snap Hook

Code	Size	A	B	C	D	WLL/kg	WT/kg
TR6203-1	1#(5/8"×59)	17.5	3.5	9	59	30	0.022
TR6203-2	2#(3/4"×66)	23.5	4	9.5	66	50	0.029
TR6203-3	3#(1"×73)	25.5	4.5	10	73	100	0.042
TR6203-4	4#(1-1/8"×80)	31.5	5	11	80	120	0.049
TR6203-5	5#(1-1/4"×85)	36.5	5.5	12	85	150	0.061
TR6203-6	6#(1-1/2"×105)	42.5	6	14	105	180	0.099



### Square Ring Swivel Snap Hook

Code	Size	A	B	C	D	WLL/kg	WT/kg
TR6203-1	1#(5/8"×59)	17.5	3.5	9	59	30	0.022
TR6203-2	2#(3/4"×66)	23.5	4	9.5	66	50	0.029
TR6203-3	3#(1"×73)	25.5	4.5	10	73	100	0.042
TR6203-4	4#(1-1/8"×80)	31.5	5	11	80	120	0.049
TR6203-5	5#(1-1/4"×85)	36.5	5.5	12	85	150	0.061
TR6203-6	6#(1-1/2"×105)	42.5	6	14	105	180	0.099



### Trigger Swivel Snap Hook

Code	Size	A	B	C	D	E	WLL/kg	WT/kg
TR6216-12	1/2×65	65	15.5	10.5	4.2	7	90	0.048



### Carabiner Hook With Eyelet

Code	Size	A	B	C	D	WLL/kg	WT/kg
TR6213-4	4×40	40	5	6	3.8	40	0.009
TR6213-5	5×50	50	6.5	7	4.8	50	0.018
TR6213-6	6×60	60	7.5	8	5.8	70	0.029
TR6213-7	7×70	70	9	8	6.8	100	0.047
TR6213-8	8×80	80	10	9	7.8	125	0.068
TR6213-9	9×90	90	11	10	8.8	140	0.096
TR6213-10	10×100	100	13	12	9.8	200	0.135
TR6213-11	11×120	120	15	16	10.8	250	0.189
TR6213-12	12×140	140	18	19	11.8	300	0.269
TR6213-13	13×160	160	20	25	12.8	350	0.365
TR6213-14	14×180	180	22	35	13.8	450	0.515

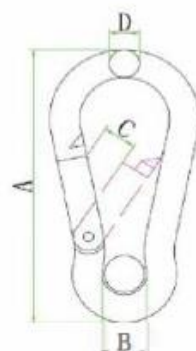

## Pulley

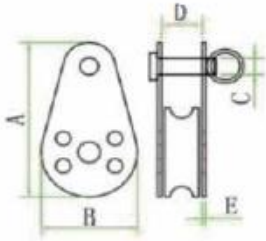

Code	Size	A	B	C	D	E	WT/kg
TR6606-25	25MM	45	26	5	11	1	0.023

## Pulley

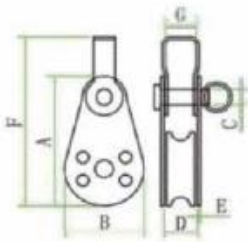

Code	Size	A	B	C	D	E	WT/kg
TR6607-25	25MM	45	26	5	11	1	0.026

## Carabiner Hook With Eyelet and Nut

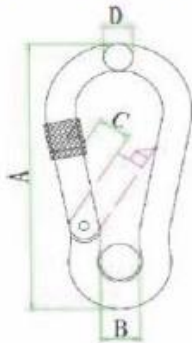

Code	Size	A	B	C	D	WLL/kg	WT/kg
TR6214-4	4*40	40	5	6	3.8	40	0.009
TR6214-5	5*50	50	6.5	7	4.8	50	0.018
TR6214-6	6*60	60	7.5	8	5.8	70	0.029
TR6214-7	7*70	70	9	8	6.8	100	0.047
TR6214-8	8*80	80	10	9	7.8	125	0.068
TR6214-9	9*90	90	11	10	8.8	140	0.096
TR6214-10	10*100	100	13	12	9.8	200	0.135
TR6214-11	11*120	120	15	16	10.8	250	0.189
TR6214-12	12*140	140	18	19	11.8	300	0.269
TR6214-13	14*180	180	22	35	13.8	450	0.515



**KAGI**  
TRADE SMARTER



MARINE HARDWARE:  
Antena Bases



AISI316 STAINLESS STEEL ANTENNA BASE

Code	L mm	W mm	H mm	D mm
TR9364A	93	64	112	25

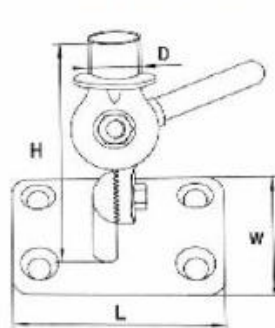

AISI316 STAINLESS STEEL ANTENNA BASE

Code	D mm
TR1220B	22mm



AISI316 STAINLESS STEEL ANTENNA BASE

Code	D mm
TR1250C	25mm







## MARINE HARDWARE: Steering Wheels



### AISI316/304 STAINLESS STEEL STEERING WHEEL



Code	SIZE	Shaft	Dish
TR0125S	11 inch	3/4 inch	25°
TR0126S	13-1/2 inch	3/4 inch	25°
TR0128S	15-1/2 inch	3/4 inch	25°

### AISI316/304 STAINLESS STEEL SPORT STEERING WHEEL WITH KNOB



Code	SIZE	Shaft	Dish
TR0130S	11 inch	3/4 inch	25°
TR0132S	13-1/2 inch	3/4 inch	25°
TR0138S	15-1/2 inch	3/4 inch	25°

### AISI316/304 STAINLESS STEEL SPORT STEERING WHEEL FINGER GRIPS & CONTROL KNOB



Code	SIZE	Shaft	Rim size
TR0150S	11 inch	3/4 inch	1 inch
TR0151S	13-1/2 inch	3/4 inch	1 inch
TR0153S	15-1/2 inch	3/4 inch	1 inch

## AISI316/304 STAINLESS STEEL STEERING WHEEL

Code	SIZE	Spoke	Dish
TR0162S	13-1/2 inch	9	15°



## AISI316/304 STAINLESS STEEL STEERING WHEEL WITH KNOB

Code	SIZE	Shaft	Rim size
TR0160S	13-1/2 inch	3/4 inch	7/8 inch
TR0161S	15-1/2 inch	3/4 inch	7/8 inch



## STAINLESS STEEL STEERING WHEEL PU FOAM With 6 wheels

Code	SIZE	Shaft	Dish
TR0170S	13-1/2 inch	3/4 inch	25°
TR0171S	15-1/2 inch	3/4 inch	25°



## STAINLESS STEEL STEERING WHEEL PU FOAM With 5 wheels

Code	SIZE	Shaft	Dish	Foam
TR0221S	11 inch	3/4 inch	25°	Black
TR0225S	13-1/2 inch	3/4 inch	25°	Black
TR0227S	15-1/2 inch	3/4 inch	25°	Black



STAINLESS STEEL STEERING WHEEL PU FOAM & KNOB With 5 wheels



Code	SIZE	Shaft	Dish	Foam
TR04010S	11 inch	3/4 inch	25°	Black

STAINLESS STEEL STEERING WHEEL PU FOAM & KNOB With 5 wheels



Code	SIZE	Shaft	Dish	Foam
TR04017S	13-1/2 inch	3/4 inch	25°	Black
TR04019S	15-1/2 inch	3/4 inch	25°	Black

STAINLESS STEEL KNOB FOR WHEEL



Code	Fits Rim Size
TR06110S	3/4 inch-1 inch
TR06120S	3/4 inch-1 inch
TR06130S	3/4 inch-1 inch





# KAGI

TRADE SMARTER



## MARINE HARDWARE: Ladders



### STAINLESS STEEL TELESCOPING DROP LADDER



Code	Step	Length Deployed	Length Stowed	Centrum Width
TR6010H	2	23.5 inch	13-1/2inch	10inch
TR6011H	3	33.8 inch	14-1/2inch	10inch
TR6012H	4	45.5 inch	15-1/2inch	10inch

### STAINLESS STEEL TELESCOPING DROP LADDER/HAND



Code	Step	Length Deployed	Length Stowed	Centrum Width
TR6020H	2	35 inch	13-1/32"	10 inch
TR6021H	3	34-3/6 inch	14-7/8"	10 inch
TR6022H	4	45-5/8 inch	15-5/8"	10 inch

### STAINLESS STEEL TELESCOPING DROP LADDER/HAND



Code	Step	Length Deployed	Length Stowed	Centrum Width
TR6030H	3	27.5 inch	12 inch	11.4 inch
TR6031H	4	36.4 inch	12.3 inch	11 inch

### STAINLESS STEEL TELESCOPING UNDER PLATFORM LADDER



Code	Step	Length Deployed	Length Stowed	Centrum Width
TR6050H	2	23.5 inch	13.5 inch	10 inch
TR6051H	3	35 inch	14.5 inch	10 inch

### STAINLESS STEEL TELESCOPING DROP LADDER



Code	Step	Length Deployed	Length Stowed	Centrum Width
TR6010H	2	23.5 inch	13-1/2 inch	10 inch
TR6011H	3	33.8 inch	14-1/2 inch	10 inch

STAINLESS STEEL NEW DIVE LADDER MIRROR POLISH

Code	Step	Length Deployed	Length Stowed	Centrum Width
TR6020H	3	35 inch	15.3inch	13-3/4"
TR6021H	4	45 inch	17.3inch	13-3/4"



STAINLESS STEEL NEW DIVE LADDER MIRROR POLISH

Code	Step	Length Deployed	Length Stowed	Centrum Width
TR6050H	3	15.3inch	13-3/4"	35 inch
TR6051H	4	17.3inch	13-3/4"	45 inch



STAINLESS STEEL UNDER PLATFORM LADDER

Code	Step	Length Deployed	Length Stowed	Centrum Width
TR6060H	2	23.5 inch	13.5inch	10 inch
TR6061H	3	35 inch	14.5 inch	10 inch
TR6062H	4	45 inch	15.5 inch	10 inch





## STAINLESS STEEL FOLDING LADDER



Code	Step	Length Deployed	Length Stowed	Centrum Width
TR6080H	2+1	7.87 inch	12.6 inch	23.6 inch
TR6081H	2+2	9.25 inch	17.7 inch	34.6 inch
TR6082H	3+2	9.25 inch	28.7 inch	42.7 inch
TR6083H	2+3	10 inch	23.9 inch	42.7 inch
TR6085H	3+3	10 inch	28.7 inch	51.8 inch

## STAINLESS STEEL BOARDING LADDER



Code	Step	Length Deployed	Length Stowed	Centrum Width
TR6090H	3+2	46 inch	36.7 inch	10 inch
TR6091H	2+3	51.2 inch	27 inch	10 inch
TR6092H	3+3	60.2 inch	36.7 inch	10 inch

## STAINLESS STEEL ADJUSTABLE SUPPORT LADDER



Code	Step	Length Deployed	Centrum Width
TR7010H	3	41.3 inch	11.4 inch

## STAINLESS STEEL ARTHROSIS LADDER

Code	Step	Length Deployed	Length Stowed	Centrum Width
TR7030H	2+1	33.5 inch	17 inch	10.2 inch
TR7031H	2+2	42.1 inch	28 inch	14 inch



## STAINLESS STEEL TELESCOPING WITH WIDER SPRING

Code	Step	Length Deployed	Length Stowed	Centrum Width
TR7060H	3	35 inch	15.3 inch	13-3/4inch
TR7061H	4	45 inch	17.3 inch	13-3/4inch



## STAINLESS STEEL TELESCOPING LADDER

Code	Step	Length Deployed	Length Stowed	Centrum Width
TR7080H	2	23.5 inch	13-1/2"	10 inch
TR7081H	3	35 inch	14-1/2'	10 inch
TR7082H	4	45 inch	15-1/2"	10 inch





# KAGI

TRADE SMARTER



## MARINE HARDWARE: Hatch

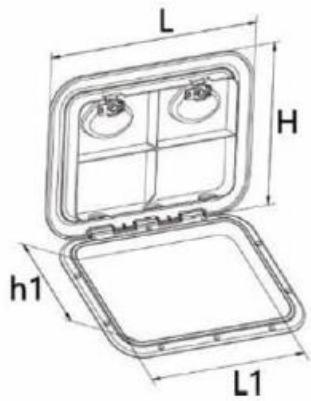

Model	H(mm)	L(mm)	h1(mm)	L1(mm)
NMRE-270-375-01	270	375	192	291
NMRE-243-607-01	243	607	168	525
NMRE-315-440-01	315	440	240	358
NMRE-353-606-01	353	606	278	524
NMRE-370-375-01	370	375	295	295
NMRE-460-510-01	460	510	383	436



Model	Size inch	d(mm)	D(mm)	Color
NMRH-004-01	4	101	143	white
NMRH-006-01	6	151	198	white
NMRH008-01	8	180	250	white

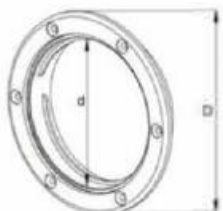

Agency Approvals:

CE





# KAGI

TRADE SMARTER



## MARINE HARDWARE: Porthole

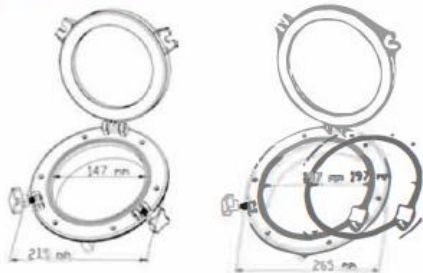

Model:01

Model:02

Model	Size(cm)	Color
NMPP1-01	21	white
NMPP2-01	21	black
NMPP1-02	26	white
NMPP2-02	26	black

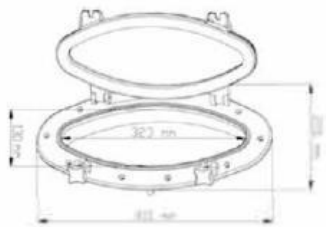

Model:03

Model	Shape	Color
NMPP1-03	Oval shape porthole	white
NMPP2-03	Oval shape porthole	black



Model:04

Model	Shape	Color
NMPP1-04	Rectangular shape porthole	white
NMPP2-04	Rectangular shape porthole	black

Agency Approvals:

CE



# KAGI

TRADE SMARTER



## Marine Equipements: Safety Equipments



Code	Weight	Certificate
TR6601W	2,5	EC,CCS
TR6602W	3,5	EC,CCS

**DESCRIPTION:**

Crust: Low pressure polyethylene

Inner Material: Hard PU

Outside Diameter: 720mm

Thickness: 105mm

Buoyancy > 14,5



Code	Type	Spec
TR6605W	LIFE JACKET	For adult

**DESCRIPTION :**

Outer material : Terylene

Inner meaterial : PE foam

Buoyancy > 12kg





Code	Type	Spec
TR6606W	LIFE JACKET	For adult

**DESCRIPTION :**

Outer material : Terylene

Inner meaterial : PE foam

Buoyancy > 7.5kg



Code	Type	Spec
TR6607W	LIFE JACKET	For adult

**DESCRIPTION :**

Outer material : Terylene

Inner meaterial : PE foam

Color : Red, Yellow, Black, Green

Buoyancy > 7.5kg



Code	Type	Cerificatia
TR6606W	Sport Life -Jacket	CCS

**DESCRIPTION :**

Outer material : 210D Terylene Oxford Textile

Buoyancy > 7.5KG

Approval CCS

Buoyant MaterialEPE Foamed

Polyethylene

Application For using on Yachts, inflatable Boats, Motorboats, Saailboats, Kayaks and on.

Characteristics

It is the only item of casual lifejacket approved by CCS

It has high-strength fabrics, protective performances and colorful appearan

Color : Red, Gray, Yellow, Graylue, Gray

Size : M, L, XL, XXL, XXXL







# KAGI

TRADE SMARTER



## Marine Equipements: Kayak Accessories



Code	A cm	B cm	Ccm	Dcm
ALS6701K	52,5	45,5	31,5	37,5



### **Kayak Seats (Backpacks are available for all models)**



Code	A cm	B cm	Ccm	Dcm
ALS6702K	53	46	34	39



ABS PLASTIC DECK HATCH COVER FOR BOAT



Code	Internal diameter	External diameter	Size
ALS6703K-6	203.2mm	152.4mm	6"
ALS6703K-8	254mm	203.2mm	8"

ABS PLASTIC DECK HATCH COVER FOR BOAT



Code	Internal diameter	External diameter	Size
ALS6704K-6	200mm	160mm	6"
ALS6704K-8	254mm	203.2mm	8"

PLASTIC ADJUSTABLE PEDALS KAYAK FOOT BRACES PEGS KIT



Code	Amm	Bmm	weight
ALS6705K	39.5	3.5	300g

MARINE HARDWARE STAND UP FISHING HAND PADDLE BOAT



Code	A cm	B cm
ALS6706k	222	49





# KAGI

TRADE SMARTER



## Marine Equipements: Standup Paddle Boards



### SA-9'6-4

Length	Width	Thick	Weight	Volume	Max inflate	Max rider weight
9'6"(290cm)	30"(76cm)	4"(10cm)	26.5lbs(10.5kg)	180L	15psi	200lbs(90kg)

### SA-10'6-4

Length	Width	Thick	Weight	Volume	Max inflate	Max rider weight
10'6"(320cm)	31.5"(80cm)	4"(10cm)	29.2lbs(12.5kg)	260L	15psi	200lbs(90kg)

### SA-11'4-4

Length	Width	Thick	Weight	Volume	Max inflate	Max rider weight
11'(335cm)	33"(76cm)	4"(10cm)	29.7lbs(12.5kg)	300L	15psi	220lbs(100kg)

### SA-12'-4

Length	Width	Thick	Weight	Volume	Max inflate	Max rider weight
12'(365cm)	34"(86cm)	4"(10cm)	30.9lbs(13kg)	300L	15psi	264lbs(120kg)





**KAGI**  
TRADE SMARTER



# Marine Equipements: Racing Paddle Boards



## SR-12'-4

Length	Width	Thick	Weight	Volume	Max inflate	Max rider weight
12'(365cm)	26"(66cm)	4"(10cm)	23.5lbs(10kg)	230L	15psi	200lbs(90kg)

## SR-12'6-4

Length	Width	Thick	Weight	Volume	Max inflate	Max rider weight
12'6(381cm)	29"(74cm)	4"(10cm)	26.5lbs(11kg)	260L	15psi	220lbs(100kg)





**KAGI**  
TRADE SMARTER



# Marine Equipements: Giant Paddel Boatos

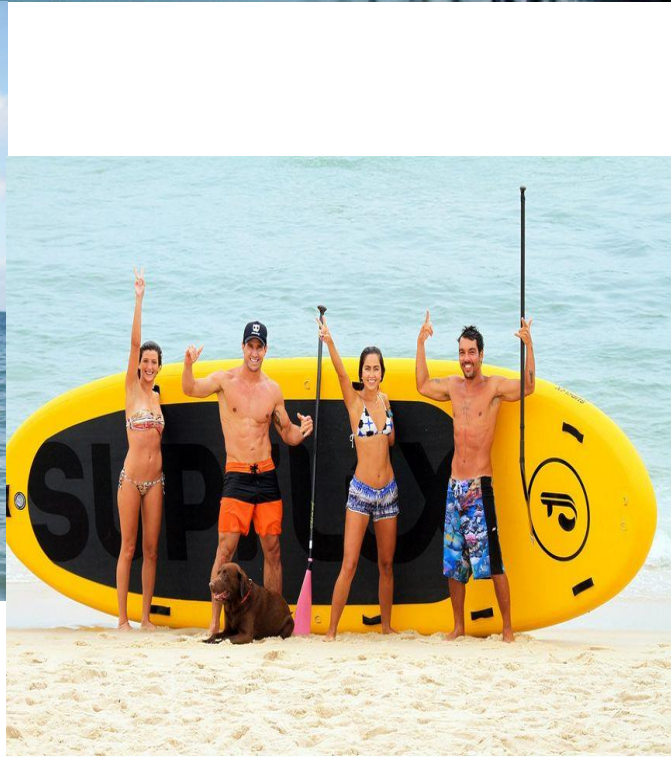

## ST-17'-8

Length	Width	Thick	Weight	Volume	Max inflate	Max rider weight
17'(518cm)	71"(180cm)	8"(20cm)	97lbs(44kg)	1345L	15psi	1170lbs(530kg)

## ST-18'-8

Length	Width	Thick	Weight	Volume	Max inflate	Max rider weight
18'(548cm)	78"(200cm)	8"(20cm)	103lbs(47kg)	1345L	15psi	1170lbs(530kg)





**KAGI**  
TRADE SMARTER



## Marine Equipements: Fishing Paddle Boards



### SF-10'6-6

Length	Width	Thick	Weight	Volume	Max inflate	Max rider weight
10'6(320cm)	33"(84cm)	6"(15cm)	26.4lbs(12kg)	270L	15psi	264lbs(120kg)

### SF-11'-6

Length	Width	Thick	Weight	Volume	Max inflate	Max rider weight
11'(335cm)	36"(91.5cm)	6"(15cm)	28lbs(12.7kg)	285L	15psi	287lbs(130kg)





# KAGI

TRADE SMARTER



## Marine Equipements: Window Inflatable Paddle Boards



### SW-10'6-4

Length	Width	Thick	Weight	Volume	Max inflate	Max rider weight
10'6(320cm)	31.5"(80cm)	4"(10cm)	29.2lbs(12kg)	260L	15psi	200lbs(90kg)

### SW-11'-4

Length	Width	Thick	Weight	Volume	Max inflate	Max rider weight
11'(335cm)	33"(84cm)	4"(10cm)	29.7lbs(12.5kg)	300L	15psi	220lbs(100kg)

### SW-12'-4

Length	Width	Thick	Weight	Volume	Max inflate	Max rider weight
12'(365cm)	34"(86cm)	4"(10cm)	130.9lbs(13kg)	300L	15psi	264lbs(120kg)



**KAGI**  
TRADE SMARTER



Marine Equipements:  
Paddle Equipments



Fins



FIXED FIN H:6CM



US FIN BOX H:23CM

Leashes & Repair kit



SURF LEASH



RACE LEASH



GLUE \* 1  
WRENCH \* 1  
BACKUP PVC \* 2

Carrying bag & Pump



BAG WITH WHEELS



BAG WITHOUT WHEELS



HAND PUMP





**KAGI**  
TRADE SMARTER



# Marine Equipments: Paddle Equipments



## Paddles



ALUMINUM PADDLE



FIBERGLASS PADDLE



CARBON FIBER PADDLE

- All Sizes available
  - All colours available
  - Logo pintable
- one time charge, no further charge



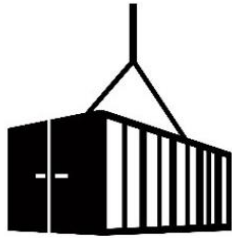

**KAGI**  
TRADE SMARTER

## CONTACT US



**KAGI**  
TRADE SMARTER  
HONG KONG - VIETNAM  
SINGAPORE - MALAYSIA

**GILLES LEFRANCOIS**

OPERATIONS & ASIAN REGION DIRECTOR

+ 60 135 1234 37

+84 778 446 247

GLF@KAGI-INTL.COM

WWW.KAGI-INTL.COM



**KAGI**  
TRADE SMARTER  
HONG KONG - VIETNAM  
SINGAPORE - MALAYSIA

**HOWARD SHI**

SALES DIRECTOR

+ 61 402 963 366 | +86 181 3875 5366

+ 61 402 963 366

HOWARD@KAGI-INTL.COM